

## Operation Manual

### 6 Ton Bench Shop Press (61889)



Read and follow the operating instructions and safety information before using for the first time.

Technical changes reserved!

Due to further developments, illustrations, functioning steps and technical data can differ insignificantly.

Updating the documentation

If you have suggestions for improvement or have found any irregularities please contact us.



The information contained in this document is subject to change without prior notice. No part of this document can be copied or duplicated in another form without the prior written consent of WilTec Wildanger Technik GmbH. The WilTec Wildanger Technik GmbH assumes no liability for any errors in this user manual or the connection diagram.

Although WilTec Wildanger Technik GmbH has made every effort to make sure that this user manual is complete, accurate and updated, errors cannot always be avoided. In the event of problems with this user manual please complete and send this form back to us.

**FAX-notification (+++49 2403 55592-15),**

**from:** \_\_\_\_\_

**Name:** \_\_\_\_\_

**Firm:** \_\_\_\_\_

**Tel/Fax:** \_\_\_\_\_

**I would like to report the following mistakes:**

---

Customer Service WilTec Wildanger Technik GmbH

e-mail: [service@WilTec.info](mailto:service@WilTec.info)

Tel:++ +49 2403 55592-0

#### **Introduction**

Thank you for purchasing this quality product. **To minimize the risk of injury by means of fire or electric shock we urge that our clients take some basic safety precautions when using this device. Please read the operation instructions carefully and make sure you have understood its content.**

Always use a grounded power connection with the appropriate mains voltage. You can find the corresponding mains voltage on the type plate. If you have any doubts about the connection being grounded, have it checked by a qualified professional. Never use a faulty electric cable.

Do not inspect the electrical part of the pressure pond filter in a wet or damp environment or when you are wet yourself and protect it from direct sunlight. Install this device in a safe location so that nobody can step on the cable, fall over or damage it. Disconnect the power plug before cleaning it and use only a damp cloth for cleaning. Avoid using cleaning agents and make sure that no liquid enters the electrical part of the pump.

The electric part of the device contains no parts that can be inspected or serviced by the user. Leave the maintenance, adjustment and repair to qualified technical personnel. In case of unauthorised intervention the 2-year warranty is no longer valid! Keep these operation instructions safe.



## Specific Safety Rules

1. Keep hands away from arbor plates and press pin during use.
2. Do not move workpiece while compressed.
3. Release load before service or maintenance.
4. Keep area under arbor plates clear. If arbor plates rest on obstruction (i.e. bolt, debris, etc.), it creates an uneven press, causing excess stress and possible breakage.
5. Avoid off-center loads. Do not operate if workpiece tilts or binds during compression.
6. Stop and release compression if you suspect imminent structural failure. If safe, inspect thoroughly and reposition before proceeding.
7. Do not compress springs or other elastic objects. They could disengage hazardously.
8. Wear approved safety goggles, heavy-duty work gloves, and steel-toe work boots during set up and/or use.
9. Keep bystanders out of work area.
10. Do not stand directly in front of the press when loaded. Do not leave the press unattended when loaded.
11. Do not operate the hydraulic ram beyond rated capacity.
12. Inspect before every use; do not use if parts are loose or damaged.
13. Ram service must be performed only by qualified repair personnel. Service or maintenance performed by unqualified personnel could result in a risk of injury.
14. When servicing a ram, use only identical replacement parts – refer to attached, product-specific parts list and diagram. Follow instructions in the “Maintenance Instructions” section of this manual. Use of unauthorized parts or failure to follow maintenance instructions may create a risk of injury.
15. Only use with accessories rated to handle the forces exerted by this tool during operation. Other accessories not designed for the forces generated may break and forcefully launch pieces.
16. Use only with ram included with this press.
17. Industrial applications must follow the national safety requirements.
18. This product is not a toy. Keep it out of reach of children.
19. Maintain labels and nameplates on the Shop Press. These carry important safety information. If unreadable or missing, contact the manufacturer for a replacement.
20. The warnings, precautions, and instructions discussed in this instruction manual cannot cover all possible conditions and situations that may occur. It must be understood by the operator that common sense and caution are factors which cannot be built into this product, but must be supplied by the operator.

### Save these Instructions

## Specifications

Maximum Capacity	6 Tons
Working Distance	5,08 cm - 10,16 cm (2" - 4")
Press Pin Diameter	Ø 1,59 cm (5/8")

## Setup - Before Use

**Note:** For additional information regarding the parts listed in the following pages, refer to the Parts List and Assembly Diagram near the end of this manual.

## Components and Controls

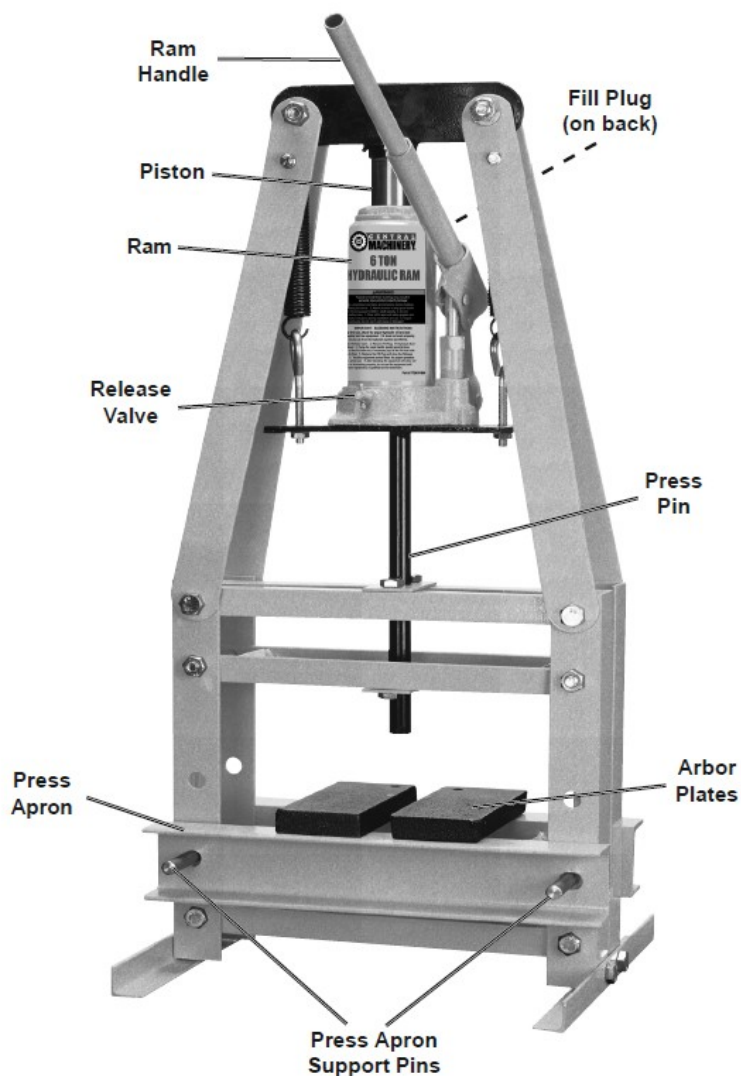

Figure A

## Assembly Instructions

Read the entire important safety information section at the beginning of this manual including all text under subheadings therein before set up or use of this product.

Inspect tool before use, looking for damaged, loose, and missing parts. If any problems are found, do not use tool until repaired. Wear approved safety goggles, heavy-duty work gloves, and steel-toe work boots during set up and/or use.

**Note:** Finger tighten all connections until assembly is done, unless instructed otherwise. Assemble on a flat, level, hard surface. Use a helper when necessary.

1. Attach Back (5) and Front (9) Posts to Foot (8) with two sets of Bolts (16), Spring Washers (21), and Nuts (24).

**Note:** Make sure holes align on Back and Front Posts.

2. Repeat for other Posts and Foot.

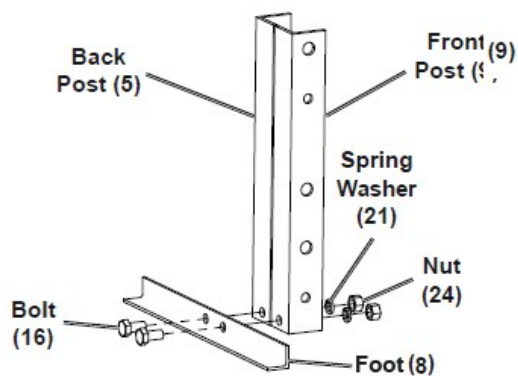

Figure B

3. Attach Spreader (7) to each side of Post assembly with two Bolts (16).

4. Repeat for other Post assembly.

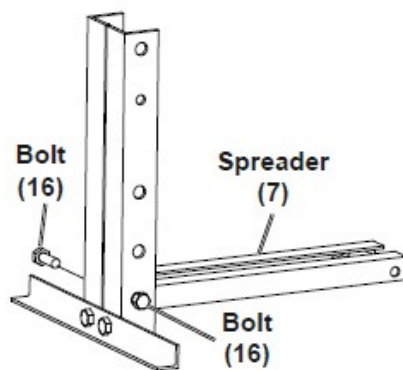

Figure C

5. Slide Press Apron (6) over Post assemblies and secure with Press Apron Support Pins (29).

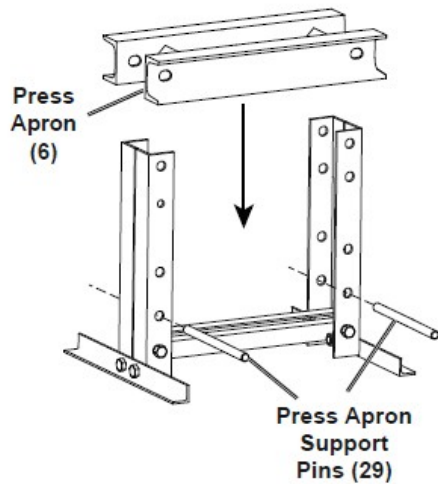

Figure D

6. Attach lower Press Pin Guide (14) to the Lower Cross Beam (2) with two Bolts (16). Tighten connections securely.

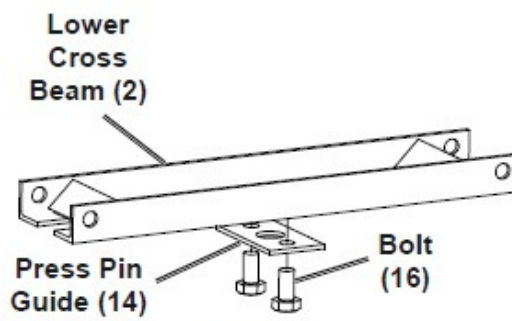

Figure E

7. Attach upper Press Pin Guide to the Upper Cross Beam (4) with two Bolts (16). Tighten connections securely.

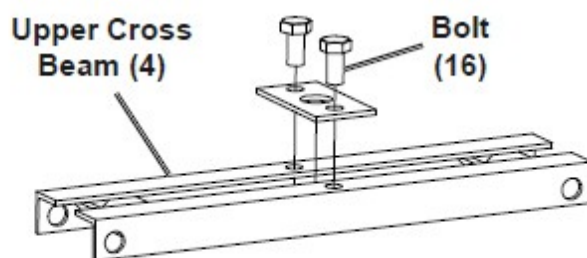

Figure F

8. Slide Lower Cross Beam assembly between Post assemblies and attach with two sets of Bolts (17), Spring Washers (21) and Nuts (24).

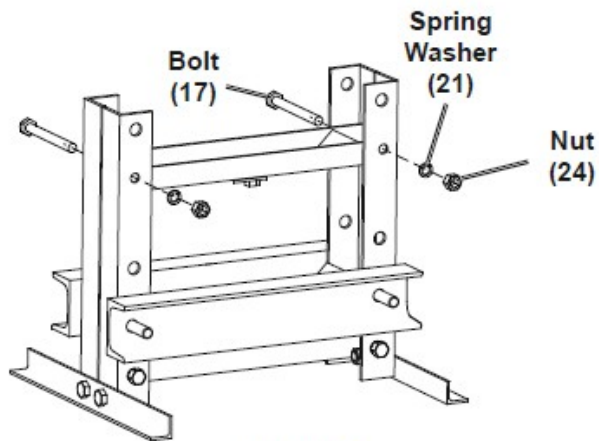

Figure G

9. Attach two Header Supports (3) together with Bolt (19), Spring Washer (23) and Nut (28), leaving a gap for the Header.

10. Repeat with other two Header Supports.

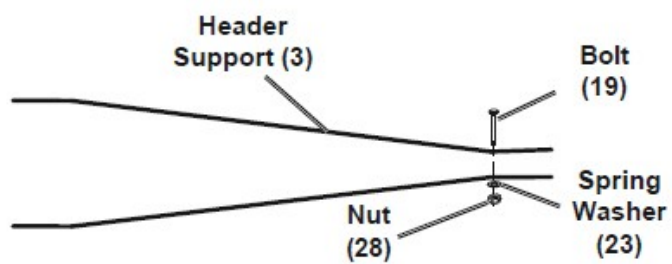

Figure H

11. Slide Header (1) between Header Support assemblies and attach with two sets of Bolts (20), Spring Washers (22) and Nuts (25).

**Note:** Tighten connections enough to avoid wobbling.

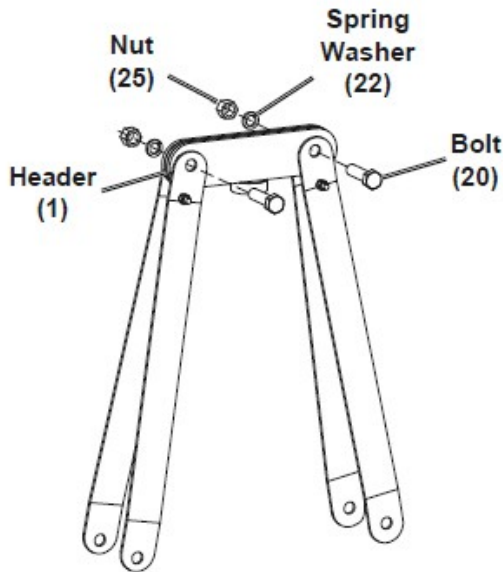

Figure I

**Note:** Use a helper for the next step.

12. Slide Upper Cross Beam assembly between Post assemblies and, at the same time, place Header Support assemblies outside Post assemblies.

13. Attach with two sets of Bolts (18), Spring Washers (22) and Nuts (25).

**Note:** Tighten connections enough to avoid wobbling.

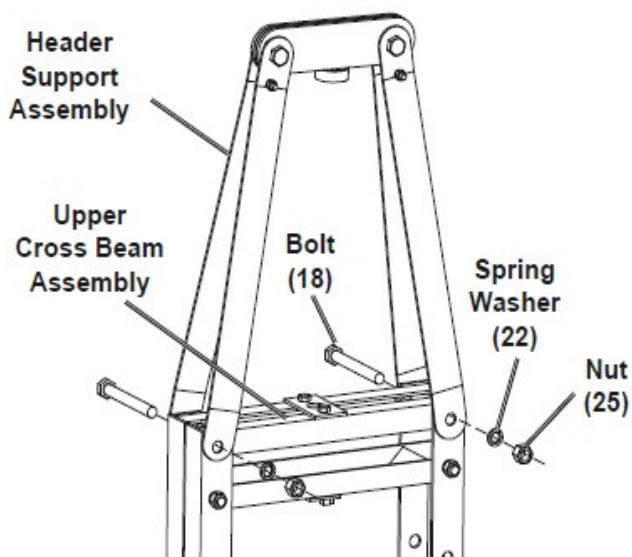

Figure J



14. Hang Springs (10) on Bolts that connect Header Supports.

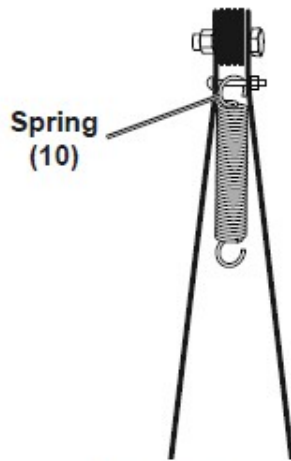

Figure K

15. Attach Eye Bolts (15) to Ram Plate (11) by threading Nuts (27) on 1,27 cm (1/2)' only.

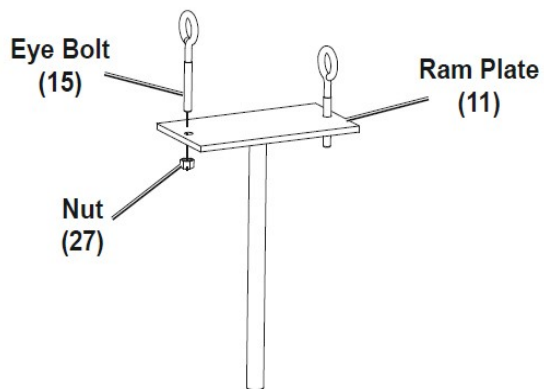

Figure L

16. Guide Press Pin through Press Pin Guides and let Ram Plate rest on Upper Cross Beam.

17. Level and square all components, then tighten all connections securely, except for Eye Bolts.

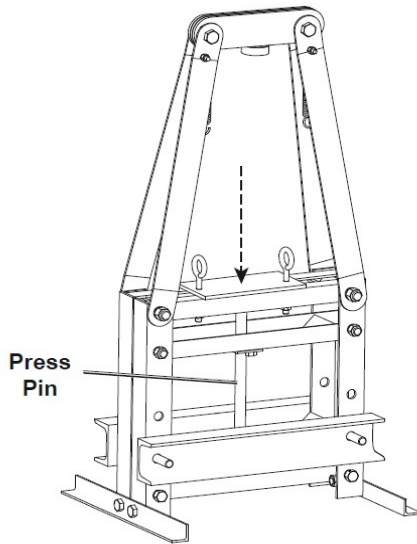

Figure M

18. Pull up on Ram Plate and attach Eye Bolts to Springs.

19. Push Ram Piston all the way down, then place Ram on Ram Plate.

**Note:** If more space is needed to install Ram, loosen Eye Bolts.

20. When Ram is in place, tighten Eye Bolts evenly, making sure the Ram Plate remains level.

21. Pump Ram Handle until Piston is seated firmly in Piston Ring, then tighten Eye Bolts as needed.

22. Place Arbor Plates on Press Apron.

23. Follow instructions in "Bleeding the Ram"

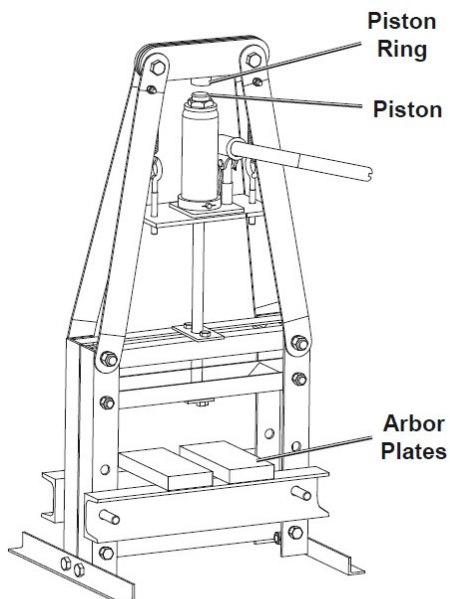

Figure N



24. Locate Shop Press on a solid, level surface, capable of supporting the weight of the Shop Press and the workpiece.

## Operating Instructions

Read the entire important safety information section at the beginning of this manual including all text under subheadings therein before set up or use of this product.

Wear approved safety goggles, heavy-duty work gloves, and steel-toe work boots during set up and/or use.

## Bleeding the Ram

**Important:** Before first use, check for proper hydraulic fluid level in the Ram. Then thoroughly test the Ram for proper operation prior to its actual use. If the Ram appears not to be working properly, it may be necessary to bleed its hydraulic system of excess air. To bleed the Ram:

1. Remove the Fill Plug.
2. Place the slot on the Ram Handle over the Release Valve.
3. Turn the Ram Handle counterclockwise to open the Release Valve.
4. Insert the Ram Handle into the Fulcrum, then pump the Ram Handle quickly several times.
5. Check the Fill Hole and, if necessary, top off with hydraulic fluid.
6. Place the slot on the Ram Handle over the Release Valve Screw.
7. Turn the Ram Handle clockwise to close the Release Valve.
8. Replace the Fill Plug.
9. Test the Ram several times before putting into use.

## General Operating Instructions

1. Adjust the Press Apron height as necessary.

**Note:** The Press Apron should be in the highest position possible with the workpiece as close as possible to the Press Pin.

2. Place the workpiece on the Arbor Plates. Adjust the Arbor Plates to support the stationary part of the workpiece.

**Warning:** Keep area under Arbor Plates clear. If Arbor Plates rest on obstruction (i.e., bolt, debris, etc.), it creates an uneven press, causing excess stress and possible breakage.

**Warning:** When pressing two items together, the items must be lined up vertically. If not, one item may forcefully eject itself sideways from the unit.

3. Close the Release Valve.
4. Pump the Ram Handle until Press Pin contacts the workpiece. Continue to pump the Ram Handle to press the workpiece.
5. After work is completed, be careful when releasing Jack pressure. Slowly open the Release Valve, allowing the Ram Plate to rise.
6. **Warning:** During the release process the Ram may rise quickly. Stay clear.
7. Store Shop Press out of reach of children.



## User-Maintenance Instructions

Procedures not specifically explained in this manual must be performed only by a qualified technician.

**Warning:** To prevent serious injury from tool failure: Do not use damaged equipment. If abnormal noise or vibration occurs, have the problem corrected before further use.

1. Before each use, inspect the general condition of the Shop Press and Ram. Check for broken, cracked, or bent parts, loose or missing parts, and any condition that may affect the proper operation of the product. If a problem occurs, have the problem corrected before further use.

### Do not use damaged equipment

2. Before each use, thoroughly test the Ram for proper operation prior to its actual use. If the Ram appears not to be working properly, follow instructions in Bleeding the Ram.

3. Change the hydraulic fluid at least once every three years. To change the hydraulic fluid:

a) With the Ram fully lowered, unhook the Springs from the Eye Bolts, then remove the Ram from the Ram Plate.

b) Remove the Filler Plug.

c) Tip the Ram to allow the old hydraulic fluid to drain out of the unit completely, and dispose of the old hydraulic fluid in accordance with local regulations.

d) Completely fill the unit with a high quality hydraulic fluid (not included) until the fluid just begins to run out of the Fill Hole.

e) Reinstall the Filler Plug.

f) Clean with a clean cloth using a detergent or mild solvent.

g) Replace the Ram onto the Ram Plate.

## Troubleshooting

**Warning:** To prevent serious injury: Use caution when troubleshooting a malfunctioning ram. Completely resolve all problems before use. If the solutions presented in the Troubleshooting guide do not solve the problem, have a qualified technician inspect and repair the ram before use. After the ram is repaired: Test it carefully without a load by raising it and lowering it fully, checking for proper operation, before returning the Ram to operation.

**Do not use damaged or malfunctioning Ram!**

### Possible Reasons

Pump stroke feels spongy	Piston will not lift all the way.	Handle moves up when ram is under load.	Fluid leaking from filler plug	Probable Solution ((Make certain that the jack is not supporting a load while attempting a solution.)
				Check that Release Valve is closed fully.
		<b>X</b>		Valves may be blocked and may not close fully. To flush the valves: 1. Lower the piston and securely close the Release Valve. 2. Manually lift the piston several inches. 3. Open the release valve and force the piston down as quickly as possible.
<b>X</b>	<b>X</b>			Ram may be low on fluid. Check the fluid level and refill if needed. Ram may require bleeding - see instructions on page 8.
			<b>X</b>	Unit may have too much hydraulic fluid inside, check fluid level and adjust if needed.

### Part List

Part	Description	Qty	Part	Description	Qty
1	Header	1	16	Bolt (M10x20)	12
2	Lower Cross Beam	1	17	Bolt (M10x100)	2
3	Header Support	4	18	Bolt (M12x110)	2
4	Upper Cross Beam	1	19	Bolt (M6x40)	2
5	Back Post	2	20	Bolt (M12x45)	2
6	Press Apron	1	21	Spring Washer (M10)	10
7	Spreader	1	22	Spring Washer (M12)	4
8	Foot	2	23	Spring Washer (M6)	2
9	Front Post	2	24	Nut (M10)	10
10	Springs	2	25	Nut (M12)	4
11	Ram Plate	1	26	Arbor Plate	4
12	Ram	1	27	Nut 8	2
13	Ram Handle	1	28	Nut 6	2
14	Press Pin Guide	2	29	Press Apron Support Pin	2
15	Eye Bolt	2			

## Assembly Diagram

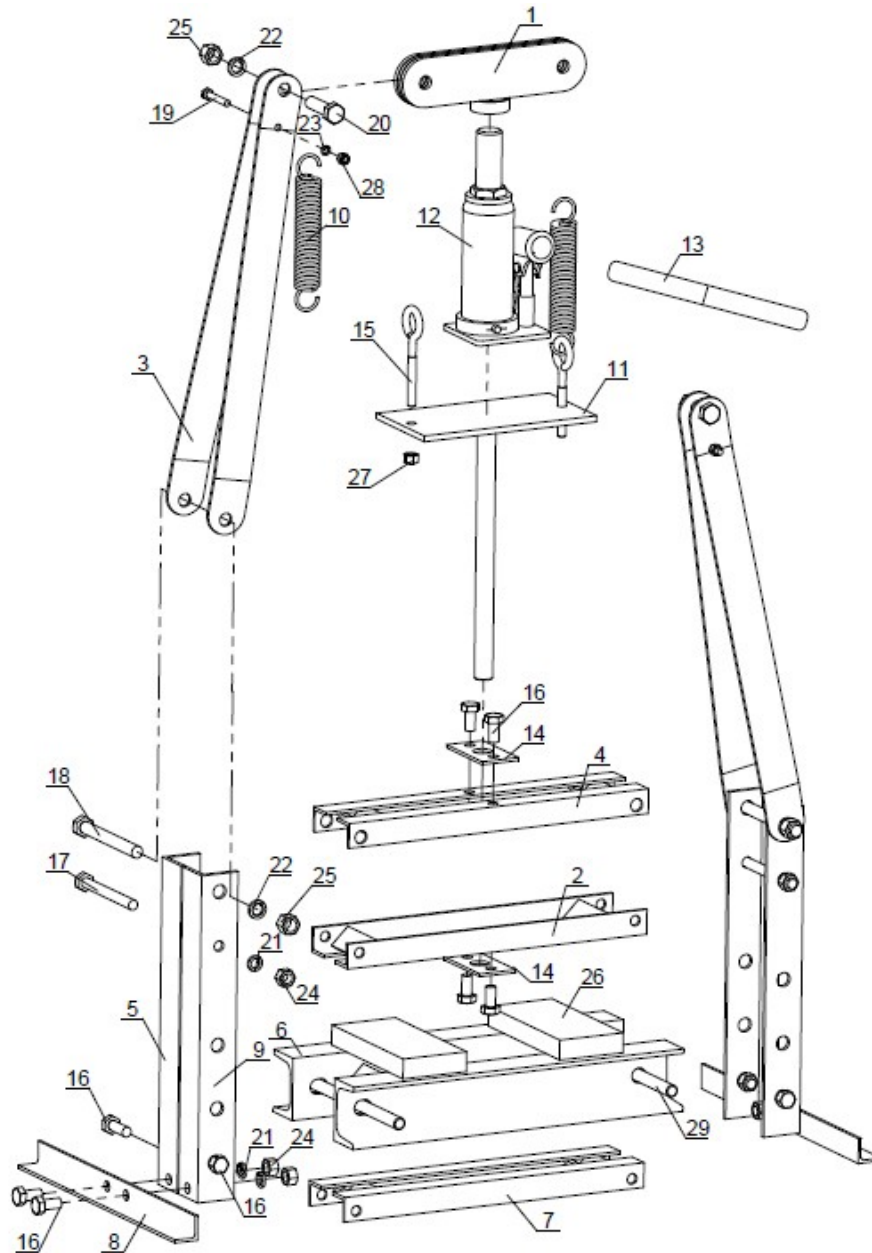

## Disposal regulations

EU guidelines regarding the disposal of scrap electric appliances (WEEE, 2012/19/EU) were implemented in the law related to electrical and electronic equipment and appliances.

All WilTec electric devices that fall under the WEEE regulations are labelled with the crossed-out wheeled waste bin logo. This logo indicates that this electric equipment must not be disposed with the domestic waste.

The company WilTec Technik GmbH has been registered in the German registry EAR under the WEEE-registration number DE45283704.

Disposal of used electrical and electronic appliances (intended for use in the countries of the European Union and other European countries with a separate collection system for these appliances).

The logo on the article or on its packaging points out that this article must not be treated as normal household waste but must be disposed to a recycling collection point for electronic and electrical waste equipment. By contributing to the correct disposal of this article you protect the environment and the health of your fellow men. Environment and health are threatened by inappropriate disposal.



Materials' recycling helps reduce the consumption of raw materials.

Additional information on recycling this article can be provided by your local community, municipal waste disposal facilities or the store where you purchased the article.

Address:  
WilTec Wildanger Technik GmbH  
Königsbenden 12 / 28  
D-52249 Eschweiler

Important notice:

The reprint or reproduction, even of excerpts, and any commercial use, even in part of this instructions manual require the written permission of WilTec Wildanger Technik GmbH.