

P1PE Petrol Pressure Washer

# P3000PWA

User Manual

**FOR YOUR SAFETY**  
You must read and understand  
this manual before use.  
Keep this manual for future  
reference.

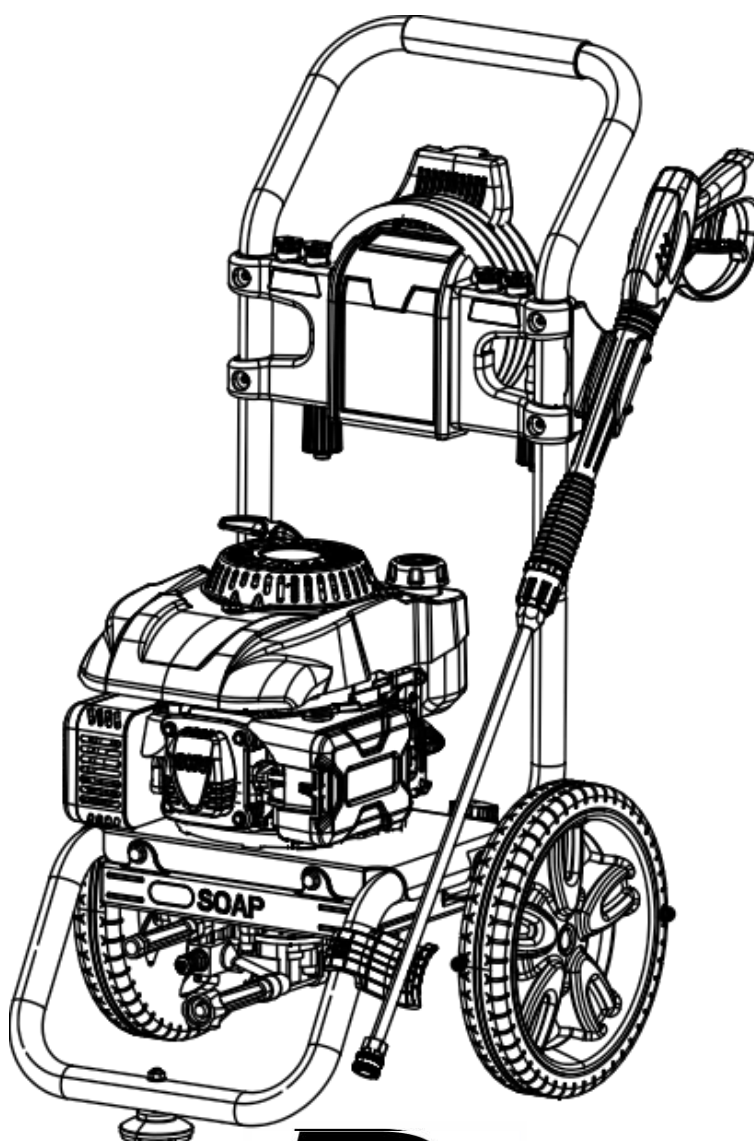

## TABLE OF CONTENTS

Pressure Washer Identification...	3
Service Record...	3
Introduction...	4
Safety Information...	4
General Safety Information...	5
Important Safety Instructions...	6
Pressure Washer Components...	7
Pressure Washer Preparation...	8
Pressure Washer Operation...	12
Pressure Washer Maintenance & Care...	15
Storage & Transport...	19
Specifications...	20
Troubleshooting...	21
Recycling & Product Disposal...	22
Declaration of Conformity...	23
Contact Details...	24

# PRESSURE WASHER IDENTIFICATION

Refer to the illustration below for the location of the serial number. Record pressure washer information in the spaces provided.

DATE OF PURCHASE: \_\_\_\_\_

PURCHASED FROM: \_\_\_\_\_

PRESSURE WASHER SERIAL NUMBER: \_\_\_\_\_

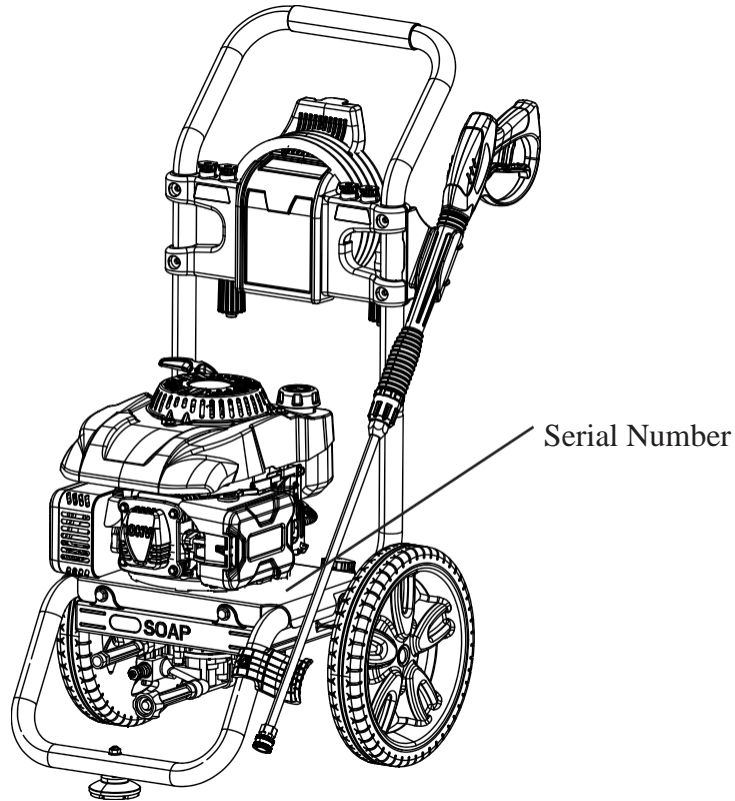

## SERVICE RECORD

Record Service Dates:

	Date	Date	Date	Date	Date	Date
Change Oil						
Change Spark Plug						
Clean Fuel Tank						
Clean Air Filter						

## INTRODUCTION

---



This manual contains special messages to bring attention to potential safety concerns, pressure washer damage as well as helpful operating and servicing information. Please read all the information carefully to avoid injury and machine damage.

---

## SAFETY INFORMATION

Before operating this pressure washer read and observe all warnings, cautions, and instructions on the pressure washer and in this Owner's Manual.

NOTE: The following safety information is not meant to cover all possible conditions and situations that may occur. Read the entire Owner's Manual for safety and operating instructions. Failure to follow instructions and safety information could result in serious injury or death.

This safety alert symbol is used to identify safety information about hazards that can result in personal injury.



A signal word (DANGER, WARNING, or CAUTION) is used with the alert symbol to indicate the likelihood and the potential severity of injury. In addition, a hazard symbol may be used to represent the type of hazard.

DANGER indicates a hazard, which, if not avoided, will result in death or serious injury.

WARNING indicates a hazard, which, if not avoided, could result in death or serious injury.

CAUTION indicates a hazard, which, if not avoided, might result in minor or moderate injury.

CAUTION when used without the alert symbol, indicates a situation that could result in damage to the engine or pressure washer.

## GENERAL SAFETY PROCEDURES

### **DANGER: CARBON MONOXIDE**

Using a pressure washer indoors **CAN KILL YOU IN MINUTES**. Pressure washer exhaust contains carbon monoxide (CO). This is a poison gas you cannot see or smell. If you can smell the pressure washer exhaust, you are breathing CO. But even if you cannot smell the exhaust, you could be breathing CO.

**NEVER** use a pressure washer inside homes, garages, crawlspaces, or other partly enclosed areas. Deadly levels of carbon monoxide can build up in these areas. Using a fan or opening windows and doors does **NOT** supply enough fresh air. **ONLY** use a pressure washer outside and far away from windows, doors, and vents. These openings can pull in pressure washer exhaust.

Even if you use a pressure washer correctly, CO may leak into the home. **ALWAYS** use a battery-powered or battery-backup CO alarm in the home. If you start to feel sick, dizzy, or weak after the pressure washer has been running, move to fresh air **RIGHT AWAY**. See a doctor. You may have carbon monoxide poisoning.



**WARNING:** The exhaust from this product contains chemicals known to cause cancer, birth defects, or other reproductive harm.



**WARNING:** This pressure washer may emit highlyflammable and explosive petrol vapors, which can cause severe burns or even death if ignited. A nearby open flame can lead to explosion even if it isn't directly in contact with petrol.

- Do not operate near open flame.
- Do not smoke near pressure washer.
- Always operate on a firm, level surface.
- Always turn pressure washer off before refueling. Allow pressure washer to cool for at least 2 minutes before removing fuel cap. Loosen cap slowly to relieve pressure in tank.
- Do not overfill fuel tank. Petrol may expand during operation. Do not fill to the top of the tank. Allow for expansion.
- Always check for spilled fuel before operating.
- Empty fuel tank before storing or transporting the pressure washer.
- Do not allow children or non-qualified persons to operate.

## GENERAL SAFETY PROCEDURES



**WARNING:** This pressure washer produces heat when running. Temperatures near exhaust can exceed 150° F (65° C).

Do not touch hot surfaces. Pay attention to warning labels on the pressure washer identifying hot parts of the machine.

Allow pressure washer to cool down after use before touching the engine or areas of the pressure washer that become hot during operation.

**CAUTION:** Misuse of this pressure washer can damage it and shorten its life.

Only use the pressure washer for its intended purposes.

Turn the engine switch to “OFF” position when the engine is not running.

The high pressure stream of water can cut through skin and cause serious injury. Do not aim the stream of water at yourself or at any one else, including animals.

Hoses and tubes can become damaged from coming in to contact with a hot engine or muffler. Always double check the hose for perforations before starting up the machine and keep it clear of the engine and the muffler.

Kickback from operation can cause the user to fall down. Always operate the pressure washer on a level and non- elevated surface to prevent the risk of falling.

Always wear safety goggles to protect from possible mishaps with the stream or detergents. Always be aware of the dangers associated with the detergents and chemicals that you are working with.

Attach all hoses before starting the engine.

**SAVE THESE INSTRUCTIONS** – This manual contains important instructions for the PIPE Pressure Washer that should be followed during installation and maintenance of the pressure washer.

Pressure washers vibrate in normal use. During and after the use of the pressure washer, inspect both the pressure washer as well as extension and power supply cords for damage resulting from vibration. Have damaged items repaired or replaced as necessary. Do not use plugs or cords that show signs of damage such as broken or cracked insulation.

## PRESSURE WASHER COMPONENTS

Use the illustrations below to become familiar the locations and functions of the various components and controls of this pressure washer.

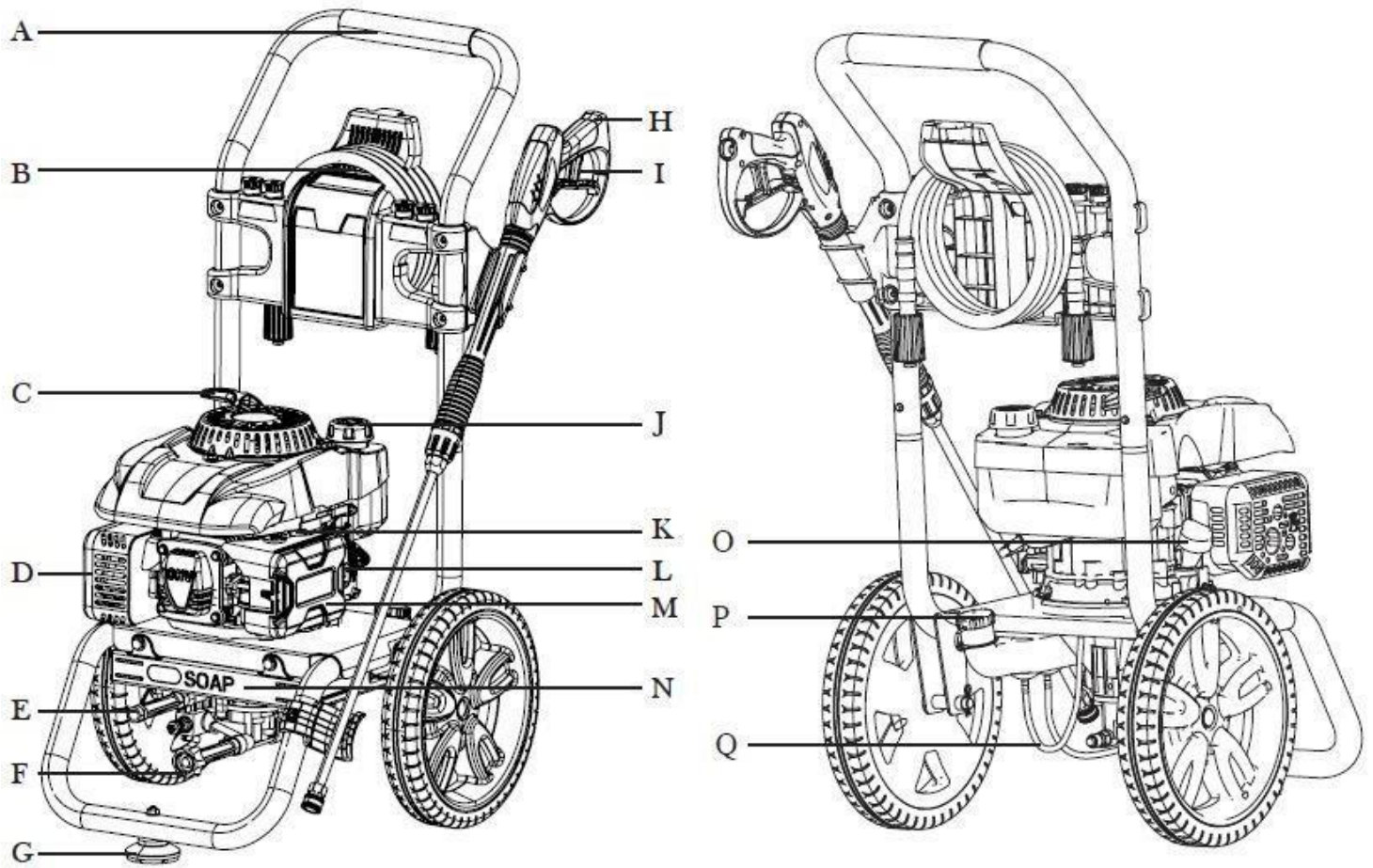

- A Handle
- B 25ft High Pressure Hose
- C Recoil Starter Handle
- D Exhaust
- E High Pressure Hose Outlet
- F Water Inlet
- G Foot
- H Spray Gun
- I Locking Trigger

- J Fuel Filler Cap
- K Choke Lever
- L Engine ON/OFF Switch
- M Air Filter
- N Soap Tank
- O Oil Filler Cap / Dipstick
- P Soap Fill
- Q Soap Drain Tube

# PRESSURE WASHER PREPARATION

Open the packaging and take out all loose parts from the box. Make sure all the components are accounted for before discarding the packaging. If any part is missing or broken, please contact our customer service department.

## PACKING LIST

- Pressure washer
- Quick start guide
- Operator's manual
- Spray gun
- Extension lance with quick-connect fitting
- High pressure lance

Upper frame

- Spray gun hook (upper)
- Spray gun hook (lower)
- Spray nozzles (4) - 0°, 25°, 40° and soap nozzle
- Foot (1)
- Nozzle cleaner

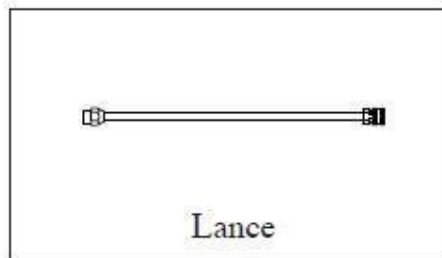
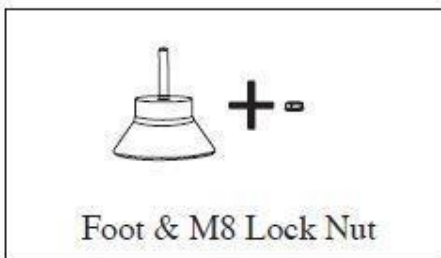
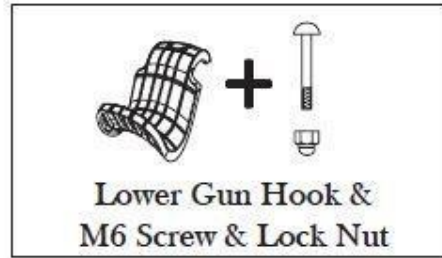
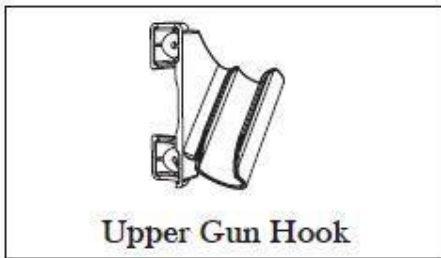

**WARNING:** Do not attempt to assemble or operate this pressure washer until you have read and understood this entire manual. If you have any problems assembling or operating this unit, please call your dealer/

**WARNING:** Do not operate this pressure washer if any of the parts are damaged or missing until the part is replaced. Using this product with damaged or missing parts can cause damage to the machine or result in serious injury or death.



# PRESSURE WASHER PREPARATION

## ATTACHING FOOT ASSEMBLY (Fig. 1)

PARTS NEEDED: 1 foot, 1 M8 lock nuts.

1 Raise or tilt pressure washer so you can line up the foot with the hole located at the centre of the frame.

2 Attach foot by inserting the bolt from the bottom up and install the acorn nut. Tighten until there is a slight crush on the frame tube. Do not over tighten.

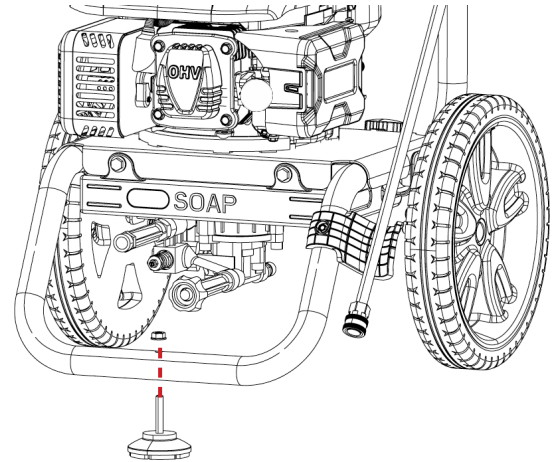
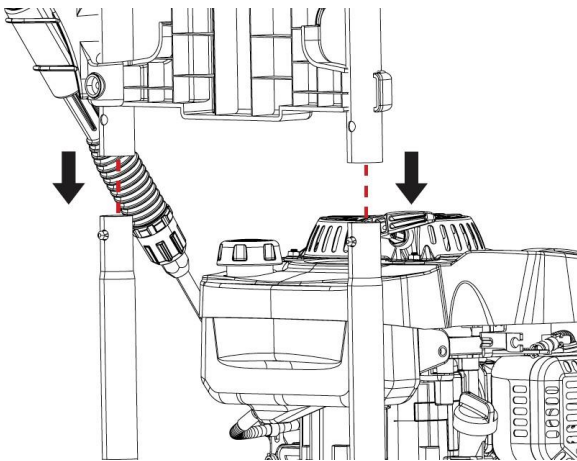

Fig. 1



## INSTALL HANDLE (Fig.2)

Install upper frame (handle) on to the lower frame by sliding the handle over the two upright tubes on the lower frame and pressing down firmly until the handle is seated and the two locking pins snap in place.

Fig. 2

## ATTACHING UPPER AND LOWER GUN HOOKS (Fig.3)

1 Align the upper gun hook with the holes. Attach using the included nuts and bolts.

2 Attach the lower gun hook. Make sure that the gun hook is straight and correctly aligned before tightening. Tighten until the nut is snug. Do not over tighten.

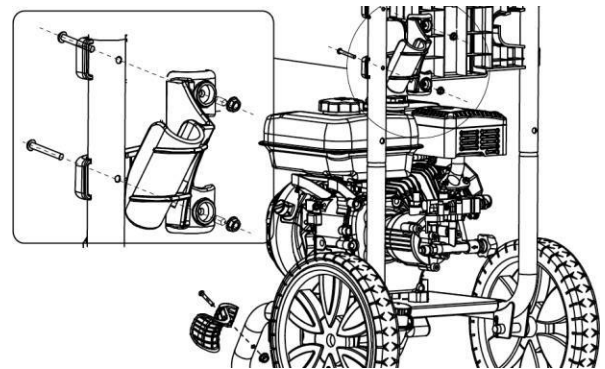

Fig. 3

# PRESSURE WASHER PREPARATION

## ATTACHING THE SPRAY GUN (Fig. 5 & 6)

Screw the spray wand and the trigger handle together until they are secure.

1. Insert the inlet coupler of the spray hose into the threaded fitting on the high pressure spray gun and thread the black nut on by turning clockwise until it is hand tight.

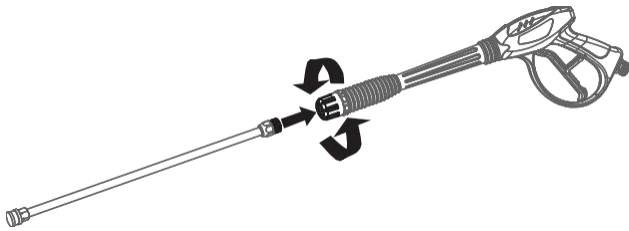

Fig. 5

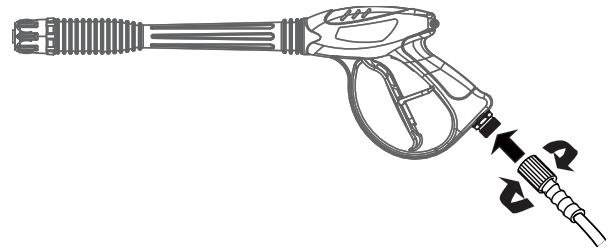

Fig. 6

## ADD ENGINE OIL

The pressure washer is shipped without oil. User must add the proper amount of oil before operating the pressure washer for the first time. The oil capacity of the engine crankcase is 500ml. For general use (above 40° F), we recommend 30W, 4-stroke engine oil.

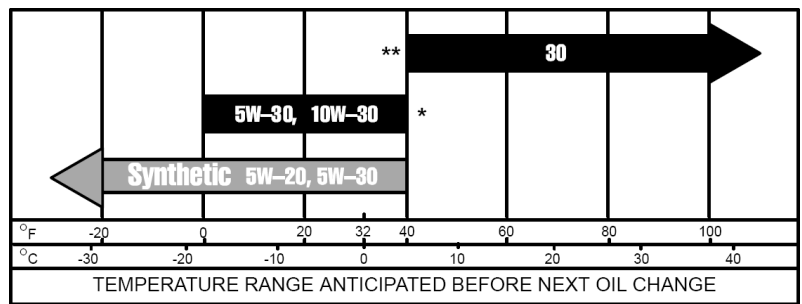

Fig. 7A

## ENGINE OIL RECOMMENDATIONS

Use a semi-synthetic SAE 15W 40 engine oil.

### To add oil, follow these steps: (Fig. 7B)

1. Make sure the pressure washer is on a level surface. Do not tilt the pressure washer to fill. Oil to flow into engine areas and damage the machine. Keep the pressure washer level!

2. Remove the dipstick from the engine. (Fig. 7B)

3. To check the oil level: wipe the dipstick with a clean rag. Insert the dipstick into the oil fill opening without screwing it in. Remove the dipstick to check the oil mark.

4. Add oil (not included) slowly until the oil mark reaches to the top of the dipstick. The capacity of the oil tank is 500ml. Do not over fill the crankcase.

Check for oil leaks and clean any spilled oil. Tighten dipstick firmly.

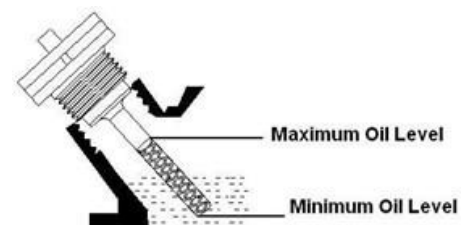
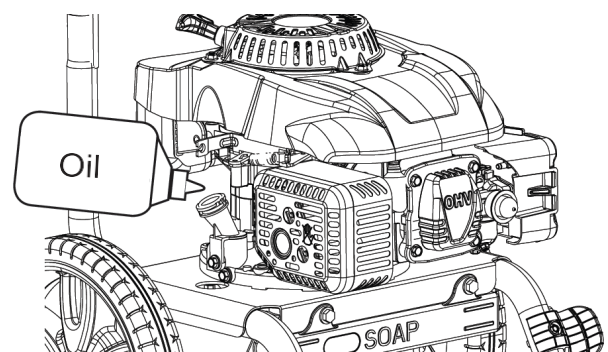

Fig. 7B

## PRESSURE WASHER PREPARATION

### ADD PETROL



**WARNING:** This pressure washer may emit highly flammable and explosive petrol vapors, which can cause severe burns or even death if ignited. A nearby open flame can lead to explosion even if not directly in contact with petrol.

Use fresh (within 30 days from purchase), unleaded petrol with a minimum of 87 octane rating. Do not mix oil with petrol.

**To add petrol, follow these steps: (Fig. 8)**

- 1 Make sure the pressure washer is on a level surface.
- 2 Unscrew fuel cap and set aside. NOTE: The fuel cap may be tight and hard to unscrew.

3 Slowly add unleaded petrol to the fuel tank. Be careful not to overfill. The capacity of the fuel tank is 1.2L. NOTE: Do not fill the fuel tank to the very top. Petrol will expand and spill over during use even with the fuel cap in place.

- 4 Reinstall fuel cap and wipe clean any spilled petrol with a dry cloth.

### IMPORTANT:

- Never use an oil/petrol mixture.
  - Only use unleaded petrol.
  - Never use old petrol.
  - Avoid getting dirt or water into the fuel tank.
  - Petrol can age in the tank and make starting difficult.
- Never store pressure washer for extended periods of time with fuel in the tank.

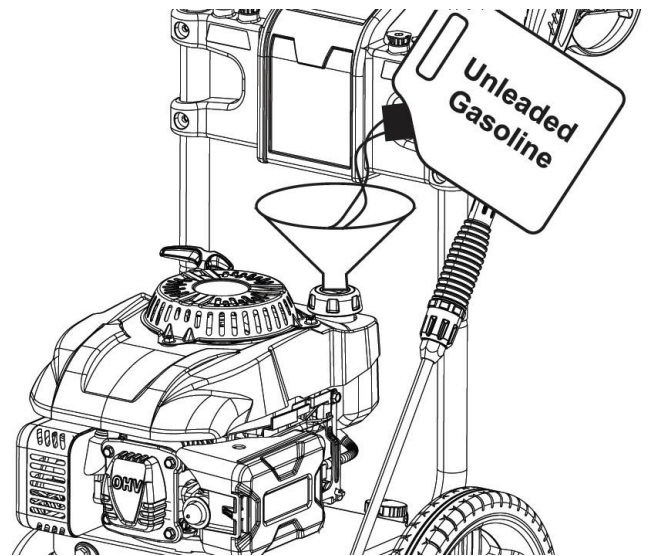

Fig. 8

**NOTE:** After completing the above preparation, the pressure washer is ready to be started.

# PRESSURE WASHER PREPARATION

## CONNECTING GARDEN HOSE TO PRESSURE WASHER (Fig. 9)

1 Run water through the hose for a few seconds to flush any debris from the hose.

2 Inspect the inlet screen and remove any debris.

3 Connect hose to water inlet and tighten by hand. There must be a minimum of 10 feet of unrestricted hose between pressure washer and faucet or shut off valve.

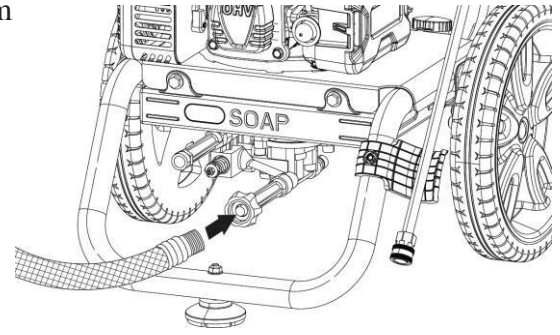

Fig. 9

## CONNECT HIGH PRESSURE HOSE TO PUMP (Fig.9)

1 Attach the end of high pressure hose to the high pressure outlet on pump.

2 Follow the same procedure with opposite end to attach high pressure hose to spray wand.

3 Turn on water.

4 Purge the system's pump of air by releasing the safety and squeezing the trigger of the spray gun.

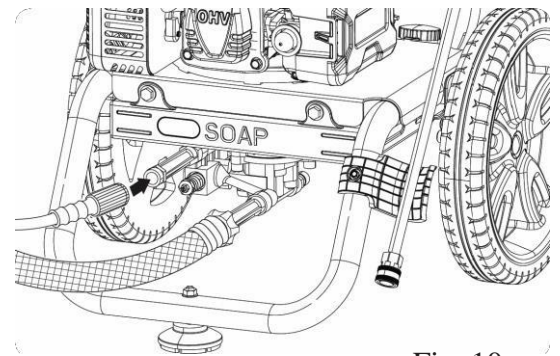

Fig. 10

## OPERATION

Before starting the pressure washer, make sure you have read and performed the steps in the “Pressure Washer Preparation” section of this manual. If you are unsure about how to perform any of the steps in this manual please contact your dealer.



**DANGER: CARBON MONOXIDE.**  
Using a pressure washer indoors CAN KILL YOU IN MINUTES.

Pressure washer exhaust contains carbon monoxide (CO). This is a poison gas you cannot see or smell. If you can smell the pressure washer exhaust, you are breathing CO. Even if you cannot smell the exhaust, you may be breathing CO.

NEVER use a pressure washer inside homes, garages, crawlspaces, or other partly enclosed areas. Deadly levels of carbon monoxide can build up in these areas. Using a fan or opening windows and doors does NOT supply enough fresh air.

ONLY use a pressure washer outside and far away from windows, doors, and vents.

# OPERATION

## USING THE SPRAY GUN (Fig. 11 & 12)

Flip the lock tab behind the trigger up or down until it clicks to apply or remove the safety. Pull back on the trigger to begin operating pressure washer. To stop water flow, release trigger.

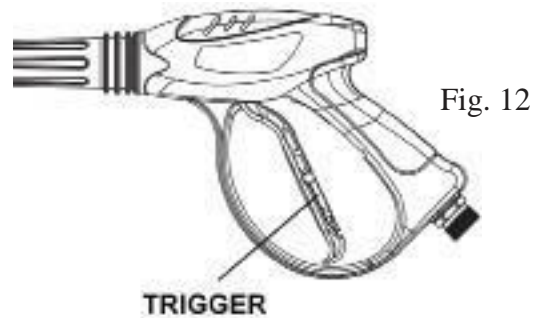
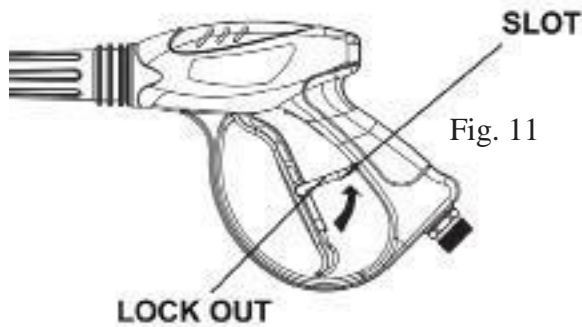

## STARTING PRESSURE WASHER (Fig. 13 & 14)

1 Place pressure washer on a level surface. Turn on water.

2 Purge the system's pump of air by releasing the safety and squeezing the trigger of the spray gun. Attach wand/lance to spray gun.

3 Slide the choke lever to the "Choke" position.

Turn the engine OFF/ON switch to the "ON" position.

4 Holding the machine with your hand, pull the recoil handle (starter cord) slowly until resistance is felt, then pull rapidly.

5 Squeeze the gun trigger and release the pressure after every failed attempt to start the pressure washer in order to reduce back pressure.

6 Let the engine run for several seconds. Then gradually slide the choke lever to the RUN position as the engine warms up until the choke is fully slid to the RUN position.

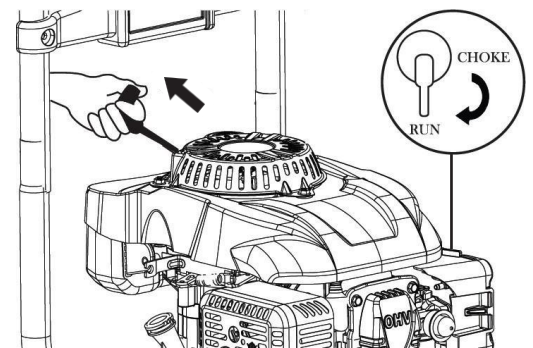
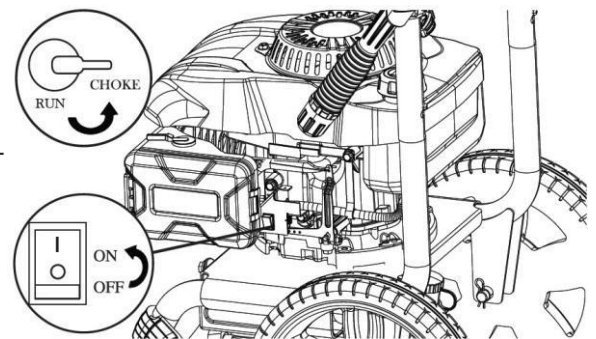

**WARNING:** Pulling the pull cord of the recoil starter rapidly can pull your arm towards the engine faster than you can let go which could result in injury. To avoid recoil, pull starter cord slowly until resistance is felt, then pull rapidly.

## STOPPING PRESSURE WASHER (Fig. 15)

1. Turn the ON/OFF switch to the OFF position.

2. Turn off water and squeeze the trigger handle to release all water pressure. Fig. 15

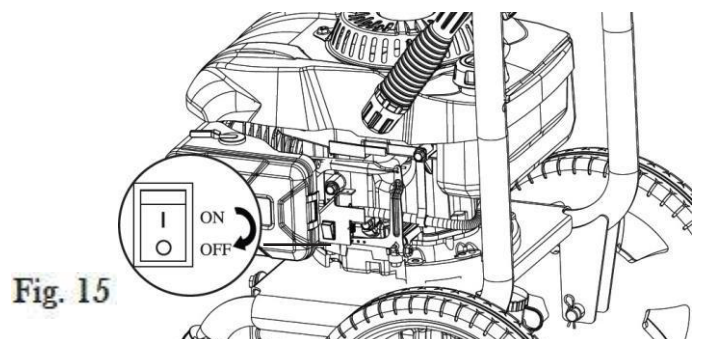

## OPERATION

### USING SPRAY NOZZLE (Fig. 16)

1. To connect or disconnect spray tip pull back on the quick-connect collar. Insert or remove spray tip then release the collar.
2. When spray tip is connected, pull on the spray tip to make sure it is secured.
3. For applying pressure washer safe detergent, use the black soap nozzle. For general cleaning use the 40° spray tip, this option is for light rinsing and cleaning on cement walkways and vehicles. For standard cleaning and blasting use the 25° spray tip, this option is for removing dirt and moss on wood and concrete. For tough cleaning jobs use the 0° spray tip this option can be used for reaching second story surfaces, or for the removal of paint, rust, oil stains, tar, gum, and other stubborn substances.

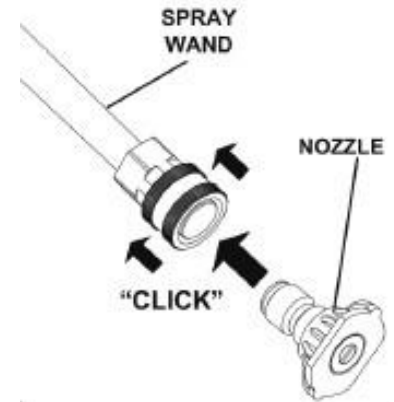

Fig.

### APPLYING DETERGENT

1. Only use the black soap nozzle for detergent.
2. Rinse surfaces with cool water before applying cleaner.
3. Prepare detergent as required. For best results follow detergent directions as supplied from manufacturer. Remove cap from the detergent container and fill. The soap tank capacity is 1.1 litres.
4. Spray detergent on surface. For best results use long, even, and overlapping strokes. Allow detergent to set for about 3 minutes before rinsing, but do not allow the detergent to dry on the surface or it may cause streaking or damage. Use good judgment.
5. To clean equipment after use, flush water through the spray nozzle for 1-2 minutes then shut off engine. Soak nozzle in a bucket of clean water to remove detergent. To empty out the soap from the pressure washer, disconnect the hose found underneath the pressure washer and let the remaining soap drain out.

### PRESSURE WASHER RELEASE VALVE

If pressure within the tank exceeds the recommended PSI, excess water will begin to spray out of the pressure release valve located next to the water inlet. This is perfectly normal and acts as a corrective measure to ensure that the right amount of pressure is being used.

However, if water seems to always be leaking, it's time for your pressure release valve to be replaced. Please call our customer service phone line to order parts and learn about the replacement process.

Pressure Release Valve

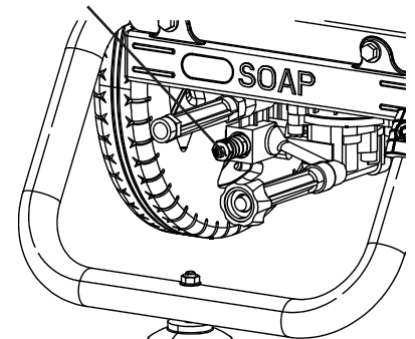

## MAINTENANCE/CARE

Proper routine maintenance of the pressure washer will help prolong the life of the machine. Please perform maintenance checks and operations according to the schedule in Fig. 17.

If there are any questions about the maintenance procedures listed in this manual, please contact your dealer.

**CAUTION:** Never perform maintenance operations with the pressure washer is running.

Recommended Maintenance Schedule		Each 8 hours or daily	First 8 hours	Every 25 hours	Every 3 months or 50 hours	Every 6 months or 100 hours	Every year	As necessary
Engine oil	Check level	x						
	Replace		x	x*	x*			x
Air filter	Check			x		x		
	Clean					x		
Spark plug	Check / clean					x		
	Change						x	x
Fuel tank	Check level	x						
	Clean						x	

Fig. 17 - Recommended maintenance schedule

\*clean/change more frequently under dusty conditions or heavy load.

### PRE-OPERATION STEPS

Before starting the engine, perform the following pre-operation steps:

- 1 Check the level of the engine oil and the fuel tank.
- 2 Make sure the air filter is clean.
- 3 Remove any debris that has collected on the pressure washer.
- 4 Check high pressure hose for damage.
- 5 Briefly run garden hose to flush out any debris or insects.
- 6 Inspect the work area for hazards.
- 7 Clean any debris that has collected around or behind the muffler, air cleaner and controls.
- 8 Use a damp cloth to wipe exterior surfaces. If dirt is caked on, use a soft bristle brush.

## MAINTENANCE/CARE

### AFTER EACH USE

Follow these procedures after each use:

1. Shut off engine and turn off water supply. Release water pressure by pointing spray gun in a safe direction and squeezing the trigger.
2. Disconnect high pressure hose, spray gun, and nozzle. Drain water from items and use a rag to wipe down the outside of the hose and spray gun.
3. Empty the water from the pump by pulling the recoil starter 6 times.
4. Store unit in a clean and dry area after it has had a chance to cool down.
5. Use of a pressure washer pump conditioner is recommended. Follow the instructions provided by the manufacturer of the pump conditioner.

### CHECKING THE OIL

Check the oil level of the pressure washer according to the Recommended Maintenance Schedule in Figure 17. The pressure washer should be checked before each use for proper oil level. This is a critical step for proper engine starting. To check the oil level:

1. Make sure the pressure washer is on a level surface.
2. Clean around oil fill. Remove dipstick and wipe the dipstick with a clean rag. Insert the dipstick into the oil fill opening without screwing in. Remove the dipstick to check the oil mark. Add oil if the oil mark covers less than one half of the dipstick.
3. Slowly add more oil and repeat step 2 until the oil mark reaches to the top of dipstick (Fig. 18). Do not over fill the crankcase. Reinstall oil dipstick.

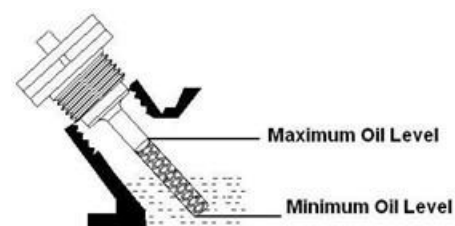

Fig. 18 - Oil Fill Opening, Dipstick and Oil Level

### CHANGING OIL (Fig. 19)

Change the oil according to the Recommended Maintenance Schedule in Fig. 17. Change the oil when the outside temperature is warm to allow for complete drainage. Change oil more often if operating under heavy load or high ambient temperatures. It is also necessary to drain the oil from the crankcase if it has become contaminated with water or dirt. The oil capacity of the pressure washer engine is 500ml. Add oil when the oil level is low. For proper type and weight of oil refer to the “add oil” portion of the “Pressure washer Preparation” section. To change oil:

1. Shut off engine. Clean the area around the oil fill cap/dipstick to keep out debris then remove oil fill cap/dipstick.

2. Place an oil pan on the ground to catch oil. Remove oil drain plug to empty out the oil from the crankcase (Fig. 19).

3. Once oil is completely drained, install the oil drain plug. Refill the engine with new oil as instructed in the manual under Adding/Checking Oil.

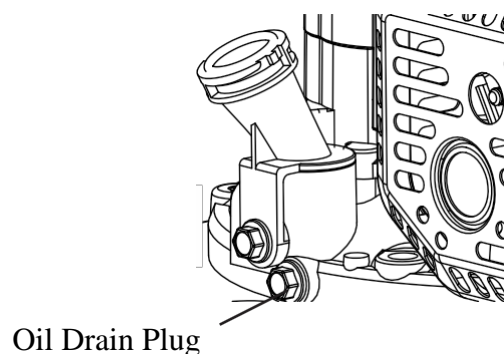

Fig. 19



# MAINTENANCE & CARE

## AIR CLEANER MAINTENANCE

Routine maintenance of the air cleaner helps maintain proper airflow to the carburetor. Occasionally check that the air cleaner is free of excessive dirt. Refer to Recommended Maintenance Schedule in Fig. 17.

1. Open the air cleaner cover.
2. Remove the air cleaner element from the casing.
3. Check and clean the air cleaner element. Replace with a new one if the element is damaged. Good element can be washed in soapy water, dried and reused. There is no need to add oil to the element.
4. Wipe off excessive oil from the air cleaner case. Small amount of oil in the element is normal and necessary for the engine to work properly.
5. Reinstall the air cleaner element and cover.

**CAUTION:** running the engine with dirty, damaged or missing air cleaner element will cause the engine to wear out prematurely.

## DRAINING THE FUEL TANK

Clean fuel tank each year or before storing the pressure washer for extended periods of time. To drain the fuel tank and carburetor:

1. Prepare a container to collect the drained fuel.
2. Clamp the fuel line near the carburetor. The fuel will flow out as soon as the fuel line is unplugged so be sure to clamp it. Remove the fuel line from the carburetor and bring to the back of the pressure washer to drain out the fuel.

**CAUTION:** Fuel will leak out during removal.

3. Unscrew the carburetor plug to drain the carburetor (Fig. 20). Be sure to drain the carburetor so the machine can function properly for the next use.
4. Re-attach the fuel line to exposed end of carburetor.

**CAUTION:** Do not dispose of the fuel in general waste. Make sure to collect it and take the fuel to your local recycling center. Do not store fuel for more than 3 months.

## DRAINING THE SOAP

To drain the soap, unplug the hose highlighted in Figure 21. Use a container to hold the draining soap. Once the soap is done draining, reconnect the hose.

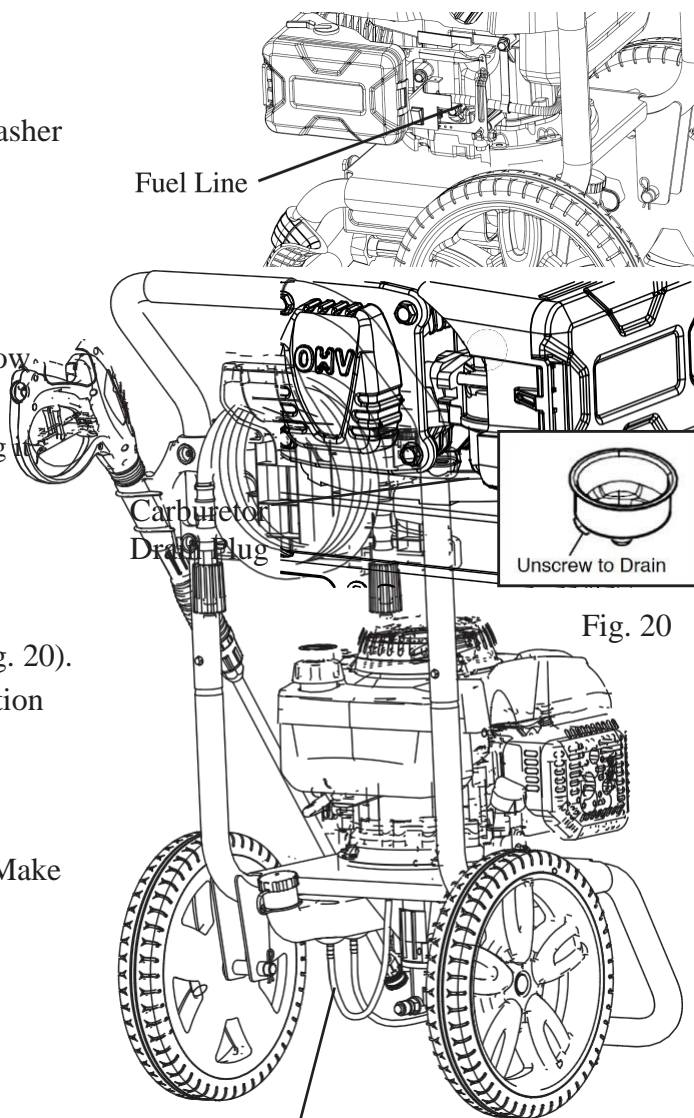

Soap Drain Hose

Fig. 21

# MAINTENANCE & CARE

---

## SPARK PLUG MAINTENANCE

The spark plug is important for proper engine operation. A good spark plug should be intact, free of deposits, and properly gapped. Refer to Recommended Maintenance Schedule in Fig. 17. To inspect the spark plug:

- 1 Remove spark plug boot. Be careful not to tear insulation or wiring.
- 2 Unscrew the spark plug from the engine using the spark plug wrench provided. There is limited space for the wrench to turn. Use both rows of holes in the spark plug wrench to gain leverage to loosen the plug.
- 3 Visually inspect the spark plug for cracks or excessive electrode wear. Replace with NGK BPR7ES spark plug.
- 4 Measure the plug gap with a wire gauge. The gap should be 0.7-0.8 mm (0.028-0.031 in).
- 5 If re-using the spark plug, use a wire brush to remove any dirt from around the spark plug base then re-gap the spark plug.

6 Screw the spark plug back into the spark plug using the spark plug wrench. Do not over-tighten spark plug. Recommended tightening of spark plug is  $\frac{1}{2}$  to  $\frac{3}{4}$  of a turn after the spark plug gasket contacts the spark plug hole. Reinstall the spark plug boot.

## CHECKING DETERGENT SIPHONING TUBE

- 1 Check the detergent siphoning tube for clogs, leaks, or tears.
- 2 Make sure the tube fits tightly in to the pump fitting.
- 3 Replace siphoning tubes if damaged.



Nozzle Cleaner

## HIGH PRESSURE HOSE

- 1 Inspect hose for cuts, bulges, or leaks which can develop from kinking or wear. If damage is found, immediately replace hose.
- 2 Inspect couplings for damage. Immediately replace hose if damage is found.

**WARNING:** Never repair a high pressure hose or use unit if the hose is damaged. If the hose is damaged replace with identical part.

## SPRAY GUN

1. Make sure the spray gun is connected securely.
2. Inspect the spray gun safety and make sure the spray gun trigger springs back upon release.

## MAINTENANCE & CARE

---

### SPRAY NOZZLE

If a pulsing sensation is felt while squeezing the trigger, the spray nozzle may be dirty or clogged and should be cleaned immediately. To clean the nozzle:

1. Shut off the engine and turn off the water.
2. Remove the nozzle from the spray wand, making sure that the nozzle is pointing away from you and in a safe direction.
3. Use the nozzle cleaner or a small paper clip to dislodge any foreign materials which are clogging or restricting the spray tip. Flush debris out of the nozzle by back flushing with a garden hose for 30-60 seconds.
4. Reconnect the nozzle to the spray wand.
5. Turn the water supply back on and start engine.

## STORAGE & TRANSPORT PROCEDURES

---

**CAUTION:** Never place any type of storage cover on the pressure washer while it is still hot.

If the pressure washer is being stored for short period of time (30 to 60 days), add stabilized fuel to the fuel tank until full. NOTE: Filling the tank reduces the amount of air in the tank and helps reduce deterioration of fuel.

Run the engine for 2 – 3 minutes allowing stabilized fuel mixture to circulate through the carburetor.

### STORING THE PRESSURE WASHER FOR EXTENDED PERIODS:

- 1 Drain the fuel tank (see “Draining the Fuel Tank” in the “Maintenance” section).
- 2 Change oil.
- 3 Do not obstruct any ventilation openings.
- 4 Keep the pressure washer in a cool dry area.

### TRANSPORTING THE PRESSURE WASHER:

1. Tighten fuel cap. Drain the fuel tank if possible (see “Draining the Fuel Tank” in the “Maintenance” section).
2. Always keep the pressure washer upright. Do not lay it down sideways.

# SPECIFICATION

---

## Pressure Washer

Max. Pressure	2800 PSI
Max. Flow	2.3 GPM
Nozzles	0°, 15°, 25°, 40°, Soap Nozzle
Gun to Lance Connection	M22 x 1.5 Threaded
Gun to Hose Connection	M22 x 1.5 Threaded
Lance Length	20" Stainless
Lance to Nozzle Connection	Quick Change
Pump	Axial Cam
Detergent Tank Capacity	1.1 Litres
Hose Diameter	1/4"
Hose Length	25'
Wheel	12"
Weight	28 Kgs

## Engine

Engine Type	4 stroke, OHV, single cylinder forced air cooling system
Spark Plug Gap	0.7 mm ±0.1 mm (0.028 in ± 0.031 in)
Spark Plug Torque	18-22N•m
Displacement	196 cc
Fuel Tank Capacity	1.2L (0.3 gallon)
Oil Capacity	500 ml
Lubrication System	Splash lubrication
Spark Plug	NGK BRP7ES

## TROUBLESHOOTING

---

Problem	Cause	Solution
Engine will not start	Engine switch is set to "OFF"	Set engine switch to "ON".
	Choke lever is set to "Run"	Turn choke lever to "Start"
	Engine is out of fuel	Add petrol
	Engine is filled with contaminated or old petrol	Change the petrol in the fuel tank
	Spark plug is dirty	Clean spark plug
	Spark plug is broken	Replace with Torch F7RTC spark plug
Water pressure is weak	Water supply is restricted	Inspect garden hose for leaks. Make sure you are using a large enough garden hose (min. 3/4 inch diameter)
	Water not turned on to full power	Turn on water source all the way
	Not using high pressure nozzle	Change nozzle
Detergent and spray do not mix	Detergent hose is not submerged or has disconnected	Make sure hose is connected and submerged in the detergent
	Black soap nozzle is needed	Use the black soap nozzle
Pump fails to produce pressure or pressure is inconsistent	Water supply is restricted	Inspect garden hose for leaks. Make sure you are using a large enough garden hose (min. 3/4 inch diameter)
	Water not turned on full power	Open water source all the way
	Nozzle is clogged	Clean nozzle
	Spray gun leaks	Check spray gun connection or replace spray gun
	Air trapped in line	Squeeze trigger handle to remove air
	Inlet hose screen is clogged	Clean inlet
	Water supply is over 100°F	Use cool water supply
	Pump is faulty	Contact service department

## RECYCLING & PRODUCT DISPOSAL

---

1. We do not offer a takeback scheme for the recovery of Waste Electrical Electronic Equipment (WEEE) & Batteries.

Instead the responsibility to dispose of WEEE and or Batteries is passed onto you by us. So when it becomes necessary to dispose of your machine, you must take it to your local Civic Amenity Site. For further information please contact your local Authority for disposal advice.

2. You **MUST** make sure that all unused oil and fuel is disposed of correctly either beforehand or at your local Civic Amenity Site.

Under NO circumstances must any fuel or oil be put down any drains.

3. Certain products contain WEEE waste which should not be disposed of in your domestic waste.

4. You **MUST** recycle WEEE in accordance with your local authority or recycling centre.

5. Certain products contain batteries which should not be disposed of in your domestic waste.

6. You **MUST** recycle batteries in accordance with your local authority or recycling centre.

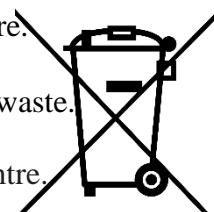

7. Unwanted packaging and materials should be stored and taken to a recycling centre so it can be disposed of in a manner which is compatible with the environment.

8. The following symbol means that you should 'Reduce – Reuse – Recycle'.

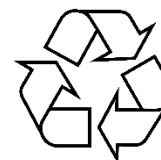

9. We are a Member of the VALPAK National Compliance Scheme and our registration number is **RM08660**.

10. For further information about disposal please contact your Local Authority.

11. You can also get more advice and guidance about recycling at the following website  
<http://www.recycle-more.co.uk>

12. Should you pass this product on to another user either sold or loaned, you **MUST** pass on this user manual. This will make sure that all other users can use and maintain this machine safely.



# DECLARATION OF CONFORMITY

---

Genpower Ltd confirms that this P1PE petrol pressure washer conforms to the following CE directives:  
2006/42/EC Machinery Directive  
2004/108/EC EMC Directive  
2000/14/EC Noise Emissions Directive  
97/68/EC NRMM Emissions Directive

## EC DECLARATION OF CONFORMITY

The undersigned. As authorised by: **Genpower Ltd**

Conforms to the Directive:-  
**2000/14/EC (as amended)**

Of the European Parliament and of the council on the approximation of the laws of the Member States relating to the noise emission in the environment by equipment for the use outdoors.

Equipment Category: **High Pressure Washer**  
Product Name/Model: **P1PE P3000PWA**  
Type/Serial No: **Petrol High Pressure Washer**  
Net installed power: **5.5**  
The technical documentation is kept by: **Roland Llewellyn, Genpower Ltd  
Isaac Way, Pembroke Dock,  
Pembrokeshire, SA72 4RW.**

The conformity assessment procedure followed was in accordance with annex V of the Directive.

Notified Body: **TüV SüV Product Service GmbH  
Zertifizierstelle, Riddlerstraße, 65  
80339 MÜNCHEN, Germany.  
Certification n° M8A 13 07 84794001**

Measured Sound Power Level: **108dB**  
Guaranteed Sound Power Level: **108dB**

A copy of this certificate has been submitted to the European Commission and the EU Member State United Kingdom.

Place of Declaration: **Pembroke Dock, SA73 4RW**  
Date: **07/03/2018**  
Signed by: **Roland Llewellyn**



Position in Company: **Managing Director**

Name and address of manufacturer or Authorised representative:

**Genpower Ltd  
Isaac Way, Pembroke Dock,  
Pembrokeshire, SA72 4RW**



## CONTACT DETAILS

---

Postal Address	Genpower Limited London Road, Pembroke Dock, Pembrokeshire SA72 4RW. UK
Telephone	+44 (0) 1646 687880
Fax	+44 (0) 01646 686198
Website	<a href="http://www.p1pe.co.uk">www.p1pe.co.uk</a>

## WARRANTY

---

To register your machine for the manufacturer's warranty, please visit:

<http://www.p1pe.co.uk/warrant>







P1 PE - Position One Power Equipment  
Isaac Way, Pembroke Dock, Pembrokeshire,  
SA724RW

[www.p1pe.co.uk](http://www.p1pe.co.uk)