

RACCORDS INOX PN20

ISO 9001:2008

BUREAU VERITAS
Certification



Dimensions : DN 1/8" au DN 4"
Raccordement : Mâle, femelle ou à souder
Température Mini : - 25°C
Température Maxi : + 180°C
Pression Maxi : 20 Bars
Caractéristiques : Fabrication par procédé de "cire perdue"
Filetage et taraudage BSP

Matière : Acier inox

RACCORDS INOX PN20
DIMENSIONS (en mm) :

- Embout tétine mâle (DN 1/4"– 2") Ref. 2035

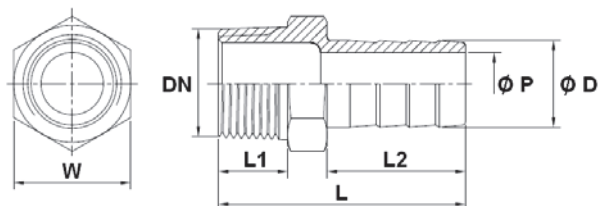

DN	1/4"	3/8"	1/2"	3/4"	1"	1"1/4	1"1/2	2"
L	43	49	56.5	60	69	70	80	88
L1	11.5	13	15	15.5	19	22	22	22.5
L2	25	29.5	33	34	39	37	47.5	53.5
Ø D	8	10	13	20	25	32	40	51.5
Ø P	4	5	7	15	19.5	26.5	33.5	44
W	15	19	23	28	37	45	50	62
Poids (Kg)	0.020	0.034	0.055	0.084	0.133	0.196	0.286	0.44

- Ecrou hexagonal (DN 1/8"– 2") Ref. 2036

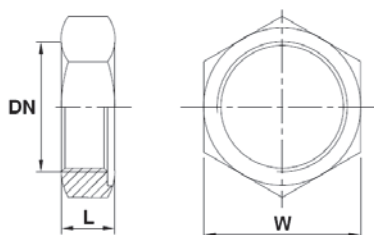

DN	1/8"	1/4"	3/8"	1/2"	3/4"	1"	1"1/4	1"1/2	2"
L	6.3	7	7.5	7.7	9.2	9	11.7	11.8	13.1
W	17.3	19.1	25.3	30.1	34.4	43.2	52	58.1	71.9
Poids (Kg)	0.008	0.009	0.018	0.024	0.032	0.048	0.086	0.097	0.155

- Bouchon femelle hexagonal (DN 1/4"– 2") Ref. 2037

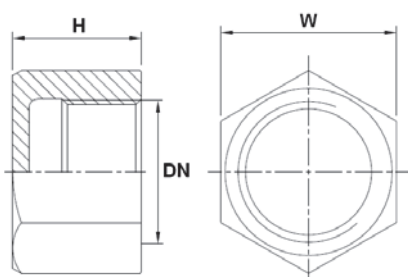

DN	1/4"	3/8"	1/2"	3/4"	1"	1"1/4	1"1/2	2"
H	17	17.5	20	20.4	27.1	30	30.3	32.3
W	17.5	21.2	25.5	30.1	37.4	47	53.2	66
Poids (Kg)	0.022	0.031	0.042	0.051	0.095	0.153	0.188	0.304

- Mamelon tube L=100 mm (DN 1/4"– 2") Ref. 2038

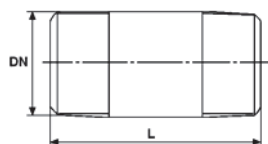

DN	1/4"	3/8"	1/2"	3/4"	1"	1"1/4	1"1/2	2"
L	100	100	100	100	100	100	100	100
Poids (Kg)	0.051	0.063	0.105	0.127	0.185	0.229	0.262	0.39