

Made in CHINA by / Fabriqué en CHINE par / Hergestellt in CHINA von /
Gemaakt in CHINA door / Fabricado en CHINA por / Prodotto in CINA da /
Fabricado na CHINA por / Vyrobené v ČINE od / Vyrobené v ČINE od /
Wyprodukowane w CHINACH przez: **Varan Motors**



Imported by / Importé par / Importiert durch / Geïmporteerd door / Importado
por / Importato da / Importado por / Importované spoločnosťou / Dovezeno
spoločnosťou / Importowane przez:

BCIE SARL
15 rue de Mensdorf,
L-5380 Uebersyren,
Luxembourg,
+352/26908036



"© 2024 BCIE SARL. All rights reserved."
"© 2024 BCIE SARL. Tous droits réservés."
"© 2024 BCIE SARL. Alle Rechte vorbehalten."
"© 2024 BCIE SARL. Alle rechten voorbehouden."
"© 2024 BCIE SARL. Todos los derechos reservados."
"© 2024 BCIE SARL. Tutti i diritti riservati."
"© 2024 BCIE SARL. Todos os direitos reservados."
"© 2024 BCIE SARL. Všetky práva vyhradené."
"© 2024 BCIE SARL. Všechna práva vyhrazena."
"© 2024 BCIE SARL. Wszelkie prawa zastrzeżone."

HAND WINCH

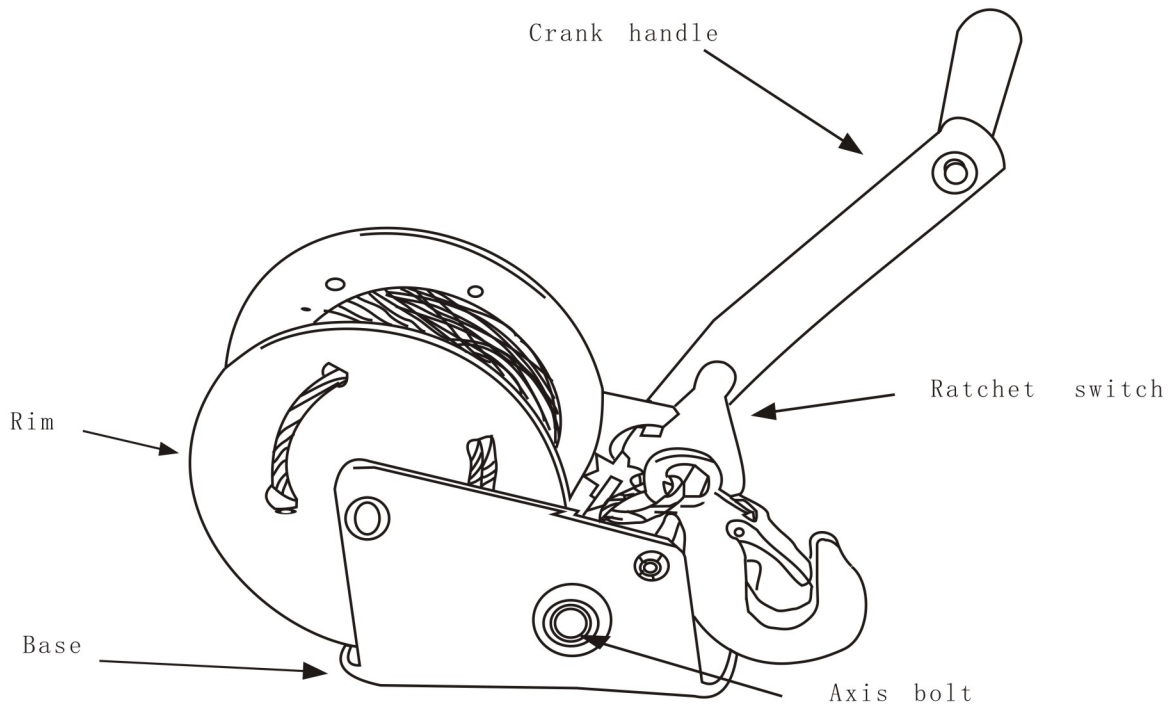

User' s manual:

1. Ratchet switch—Then are 3 positions for this ratchet switch:The higher position is for pulling, the lower position is for releasing, the middle position is for both pulling and releasing but can only be used when unloaded. When the winch is loaded, hold the crank handle tightly if you want to change the switch position.
2. Before using, install the winch on a firm and flat surface. To install it, put the ratchet switch on the middle position and pull the cable out until the holes on the bottom of the base are visible. Then use at least 3 sets of 3/8" bolts and locking nuts, in a triangle pattern, to fix the base on the surface. Use an extra metal or hardwood board when necessary.
3. Then install the crank handle to the axis bolt with nut.
4. Put the ratchet switch on the higher position and turn the crank handle clockwise to pull. Put the ratchet switch on the lower position and turn the crank handle counterclockwise to release.

Caution:

1. Never overload!
2. This winch is designed for pulling, not for lifting!
3. Never put your hand or anything else near the gear, rim and rolling cable. Always wear gloves when using the winch.
4. Never try to repair or disassemble the winch when there is a problem. Ask a machinist or specialist for help.
5. When replacing the cable, make sure that the end of the cable comes through the 4 holes on the side of the rim, and tie a knob or weld the end tip of cable to the cable, to prevent the cable from coming out.
6. Use grease for axis and gears before depositing for a long time.