



Woodworking machinery at its best!

**8" x 5" PLANER THICKNESSER
OWNERS MANUAL**

MODEL: PT200



**Charnwood, Cedar Court, Walker Road, Hilltop Industrial Estate, Bardon,
Leicestershire, LE67 1TU**

**Tel. 01530 516 926 Fax. 01530 516 929
email: sales@charnwood.net website: www.charnwood.net**

GENERAL SAFETY RULES



WARNING: Do not attempt to operate the machine until you have read thoroughly and understood completely all instructions, rules, etc. contained in this manual. Failure to comply may result in accidents involving fire, electric shock, or serious personal injury. Keep this owner's manual and review frequently for continuous safe operation.

1. Know your machine. For your own safety, read the owner's manual carefully. Learn its application and limitations, as well as specific potential hazards pertinent to this machine.
2. Make sure all tools are properly earthed.
3. Keep guards in place and in working order. If a guard must be removed for maintenance or cleaning, make sure it is properly replaced before using the machine again.
4. Remove adjusting keys and spanners. Form a habit of checking to see that all keys and adjusting spanners are removed from the machine before switched it on.
5. Keep your work area clean. Cluttered areas and workbenches increase the chance of an accident.'
6. Do not use in dangerous environments. Do not use power tools in damp or wet locations, or expose them to rain. Keep work areas well illuminated.
7. Keep children away. All visitors should be kept a safe distance from the work area.
8. Make workshop childproof. Use padlocks, master switches and remove starter keys.
9. Do not force the machine. It will do the job better and be safer at the rate for which it is designed.
10. Use the right tools. Do not force the machine or attachments to do a job for which they are not designed. Contact the manufacturer or distributor if there is any question about the machine's suitability for a particular task.
11. Wear proper apparel. Avoid loose clothing, gloves, ties, rings, bracelets, and jewellery which could get caught in moving parts. Non-slip footwear is recommended. Wear protective hair covering to contain long hair.
12. Always use safety glasses. Normal spectacles only have impact resistant lenses. They are not safety glasses.
13. Do not over-reach. Keep proper footing and balance at all times.
14. Maintain the machine in good condition. Keep the machine clean for best and safest performance. Follow instructions for lubrication and changing accessories.
15. Disconnect the machine from power source before servicing and when changing the blade.
16. Never leave the machine running unattended. Turn the power off. Do not leave the machine until it comes to a complete stop.
17. Do not use any power tools while under the effects of drugs, alcohol or medication.
18. Always wear a face or dust mask if operation creates a lot of dust and/or chips. Always operate the tool in a well ventilated area and provide for proper dust removal. Use a suitable dust extractor.

ADDITIONAL RULES FOR PLANER/THICKNESSERS

1. This machine is designed for use with wood. Attempting to plane or thickness any other materials will result in damage to the machine, potential fire risk and/or health hazards.
2. The machine is designed for indoor use only.
3. Connection to a suitable dust extraction system is highly recommended. If you must use the machine on its own, you will need to stop it, unplug it from the mains and thoroughly clean it at regular intervals. Continuing to use the machine when it is clogged with shavings will result in damage to it, potential fire risk and/or health hazards.
4. The machine should be bolted to a bench or suitable stand.
5. Always hold the work firmly on to the table, using the push pads provided.
6. Never use the planer/thicknesser with the guard and/or dust hood removed.
7. If planing or thicknessing a long piece of timber, provide additional support at the same height as the table.
8. Switch the machine off and unplug it before removing any debris.
9. Be aware of the possibility of kickback.
10. Do not modify this machine in any way or use it or anything other than its designated purpose. Neither the manufacturer nor the suppliers will be liable for any damage or injury caused by incorrect assembly, operation or electrical connection of this machine.



Risk of Injury!
Never reach into
a running cutterblock



Eye
Protection



Ear
Protection

Charnwood PT200 Specification

Voltage and frequency	240V at 50hz.
Motor (Carbon brush)	1500w (2hp)
Planer width	200mm (8")
Maximum planing cut	2mm
Work Table	740 mm x 210 mm
Table height	360 mm
Fence tilt	90 to 135°
Max thicknessing cut	2mm
Thicknessing capacity	5 to 125mm
Feed speed	8 m/min
Number of blades	2
Cutter block rotation	9,000 rpm
Dimensions (WxDxH)	850mm x 430mm x 470mm
Weight	28kg
Rating	Hobby
Warranty	1 Year

Rating Description

Hobby: Suitable for Weekend DIY'ers and woodworking enthusiasts.

Generally lighter weight machines with lower power ratings and smaller tooling capacities. Typically only ever used by one person for short periods of time or longer periods of time infrequently. Machinery should be well maintained in a clean, dry environment such as a home workshop, garage or timber shed. **Expected maximum use of 100 hours annually.**

Please Note: Using a product in excess of its rating will void the manufacturer's free warranty.

Unpacking



Open the top of the carton

Remove the top half of the polyfoam packaging.

Carefully unpack all of the contents and lift the machine onto a bench.



Lay out the parts and familiarise yourself with them.

Read the manual.

Please do not dispose of the packaging until you have fully assembled and tested the machine.

In the unlikely event there is a fault, you will need to re-use the packaging.

Assembly

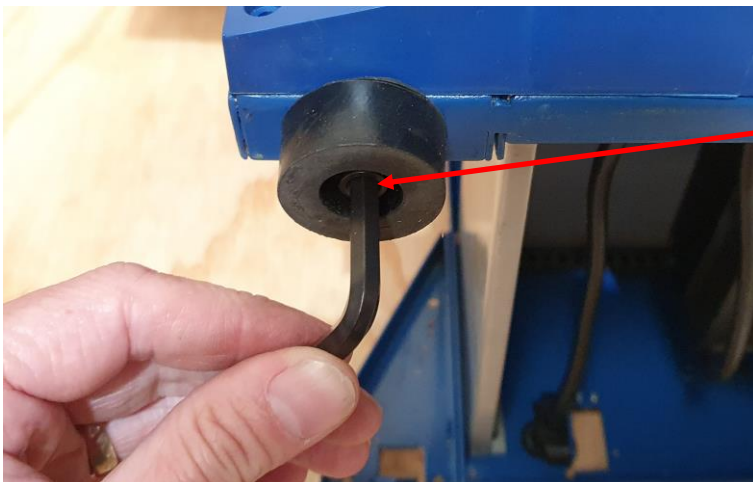

Clean the aluminium tables with a degreaser, such as WD-40.

Use M8 x 20mm cap head screws to attach four plastic feet to the underside of the body.

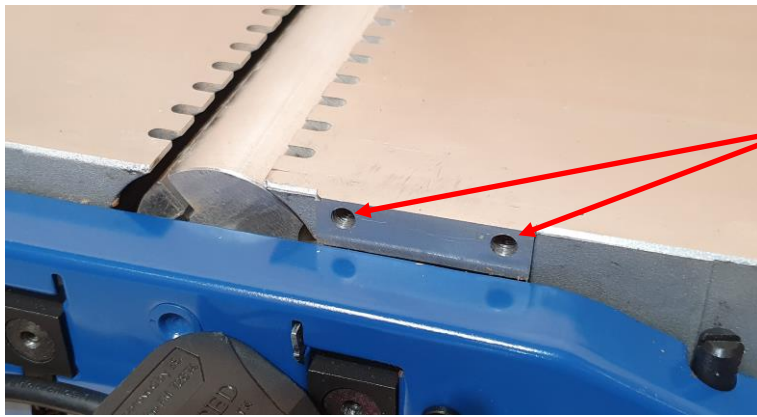

Place the machine upright

Locate two tapped holes on the side edge of the table

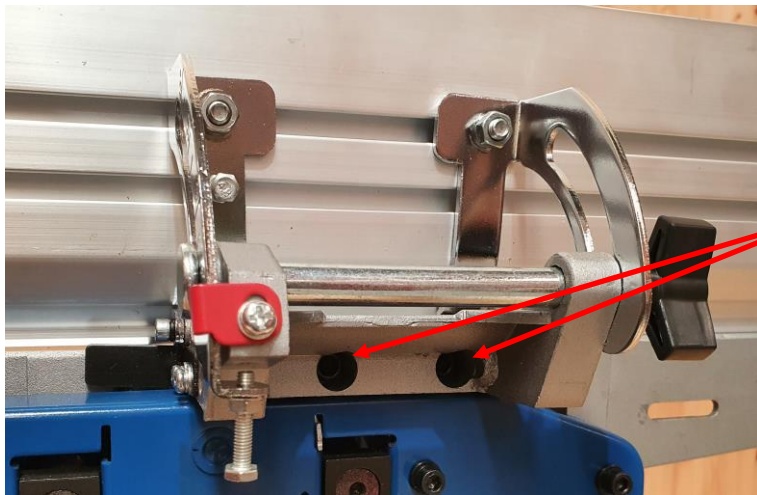

Fit the fence to the table, using the two M5 x 20mm cap head bolts and washers.



Fit the bridge guard arm pivot bolt

Screw the pivot bolt, with washer fitted, from the inside of the table, until the full length of the thread projects beyond the edge of the table.

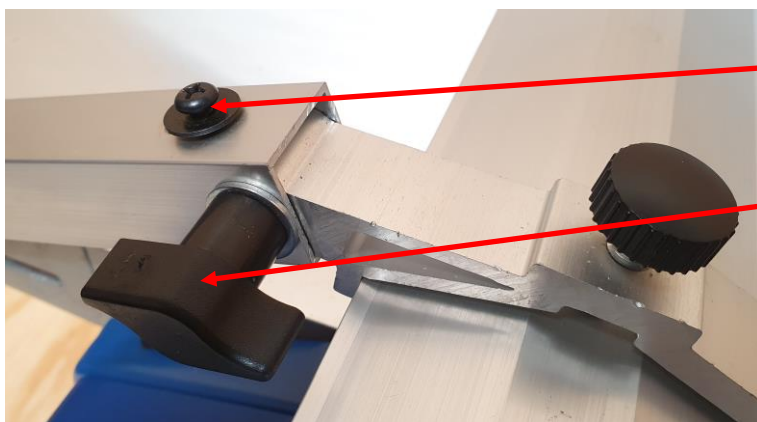

Slide the bridge guard into the end of the bridge guard arm and secure using the screw and washer.

Secure in place using the M6 coach bolt, washer and plastic knob.



Fit the bridge guard support arm onto the bridge arm pivot bolt.

Secure the guard by screwing the wing nut onto the threaded bolt.

Insert the locking knob, with washer fitted, through the curved slot in the bridge arm. Set the bridge guard arm to the desired angle and tighten.



The dust extraction hood has a 65mm diameter outlet for connecting the extractor hose.

If you are using a 100mm diameter dust extractor hose, fit the adaptor.



PLEASE NOTE : THE MACHINE IS FITTED WITH AN INTERLOCKING SAFETY SWITCH AND WILL NOT RUN WITHOUT THE DUST EXTRACTION HOOD CORRECTLY FITTED

The hood can be fitted in two different ways, depending on what type of operation is being carried out:
Planing or Thicknessing

The hood is locked in place using two locking latches which push into a receiver. One located on each side of the table.

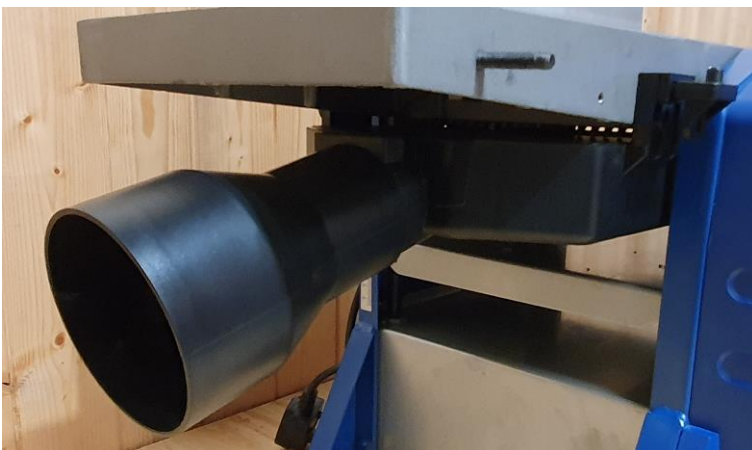

Planing Operations

The dust extraction hood must be fitted underneath the outfeed table and locked in place using the two locking latches.

Thickening Operations

Remove the fence

The extraction hood is then fixed on top of the outfeed table and locked in place using the two locking latches.



Fit the crank handle onto the shaft located at the side of the infeed table.

Rotating this crank handle raises or lowers the height of the thickening table.



Using the Planer Thickener

Guide Fence

Outfeed Table

Bridge Guard Position Lock

Planing Depth Scale

Thickening Bed Height Adjuster

Infeed Table

Thickening Table

Planing Depth Adjuster

On / Off Switch

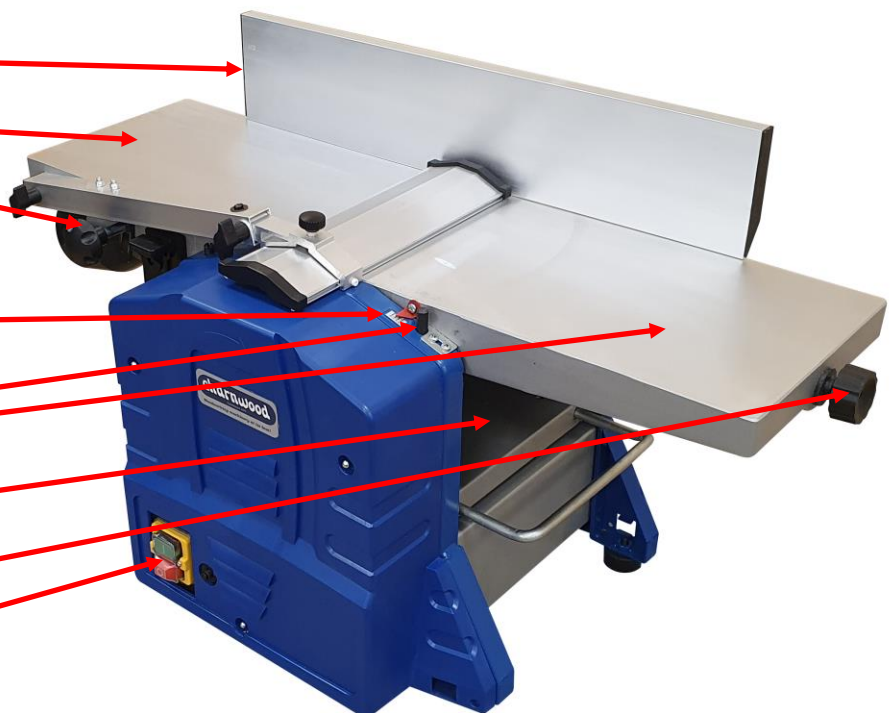

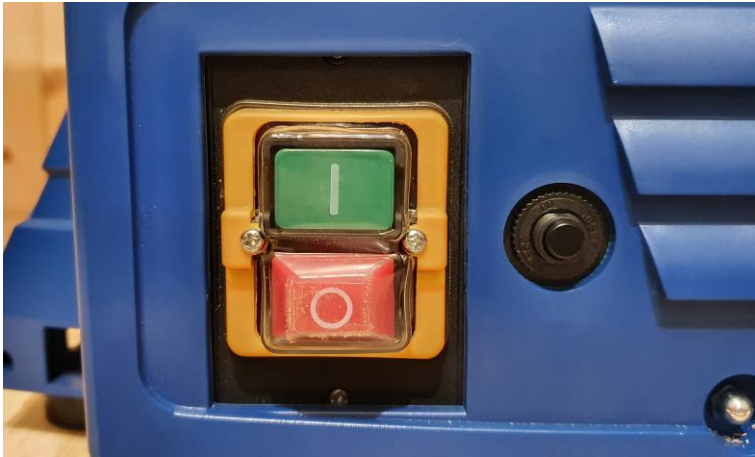

Starting And Stopping

To turn on, press the green button. Wait for the knives to reach their maximum speed of rotation before commencing with the cut.

The machine is fitted with an NVR (No Voltage Release) switch.

This type of switch is designed so that if the machine is disconnected from the mains whilst running and then reconnected, the motor will not automatically restart.

Planing Function

Standing with the switch side as the front. The direction of feed is Right to Left.

Fit the extraction hood under the outfeed table and clamp it into place.

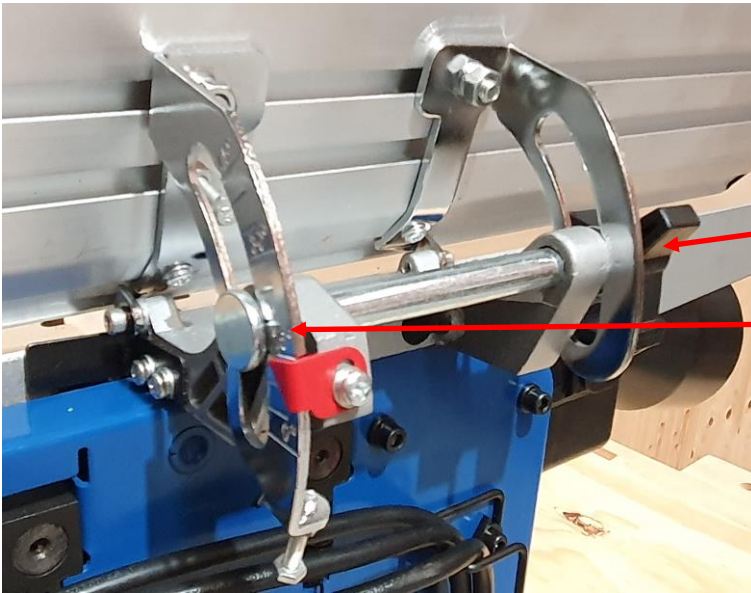

Set The Angle Of The Guide Fence

The guide fence can be set to any angle from 90 to 45 degrees. There are adjustable pre-set stops for those two positions.

The guide fence is locked and unlocked by using this locking knob.

Other angles can be set by reading off the scale.



Set the Depth of Cut

Turn the plastic knob, located on the end of the infeed table, clockwise to decrease the depth of cut.

The planing scale shows mm increments from 0 to 3. (Max. recommended is 2mm per pass)

As a general rule, set the depth at 1mm and, if necessary, make 2 or 3 passes until the desired result is achieved.



Position the bridge guard so it covers any exposed part of the knives.

Use the push pad to hold the work piece firmly down against the table, feed the work piece across the knives, onto the out-feed table.

When working with very thin material, set the bridge guard all the way across to the fence.

Then set the height of the bridge guard, so the work piece can pass underneath it.

Thickening Function

Standing with the switch side as the front. The direction of feed is Left to Right.
Fit the extraction hood on top of the outfeed planing table and clamp in place.



Use the crank handle to adjust the height of the thickening bed to match the work piece.

The maximum depth of cut when thickening is 2mm. A feed height restrictor bar prevents a cut of more than 2mm being made.

Standing in front of the machine, hold the work piece so it is flat against the thickening table and gently push forward. Release the work piece when you will feel the drive roller take hold and feed it past the knives.

Move around to the other end of the machine to support the piece by hand as a second drive roller feeds it out of the machine.

Repeat as many times as necessary to achieve the required dimensions of the piece.

Each pass, rotate the crank handle clockwise one turn to raise the bed by 2mm.

The actual dimension can be read from the thickness scale.

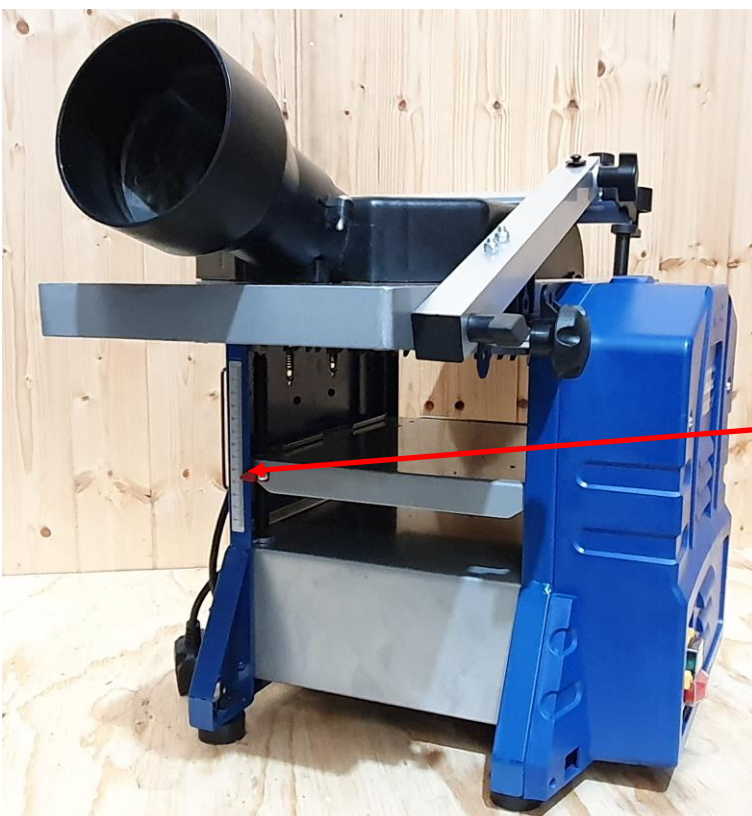



The out-feed end of the thicknesser bed has a pull-out support that can be extended to support the work piece as it emerges.

General Guide

When faced with a rough sawn piece of timber which requires planing on all 4 sides and taking down to a specific finished dimension, follow this guide:

- Set the machine up for planing.
- Identify the flattest of the two wider faces on the timber. (Face 1 on diagram)
- Pass that side over the planer as many times as necessary until a flat and smooth finish is achieved.
- Hold the planed side firmly against the guide fence (set at 90 degrees to the bed) and pass the narrow side (Face 2 on diagram) over the planer as many times as necessary until a flat and smooth finish is achieved.
- You should now have two planed sides at 90 degrees to each other.
- Set the machine up for thicknessing.
- Pass the timber through the thicknesser with the wider, already planed side (Face 1 on diagram) facing down against the thicknessing bed. Continue until the desired thickness for the timber is reached.
- Finally, pass the timber through the thicknesser with the planed narrow side (Face 2 on diagram) facing down against the thicknessing bed. Continue until the desired thickness for the timber is reached.



Knife Removal and Replacement

Disconnect from the power supply before starting any maintenance.

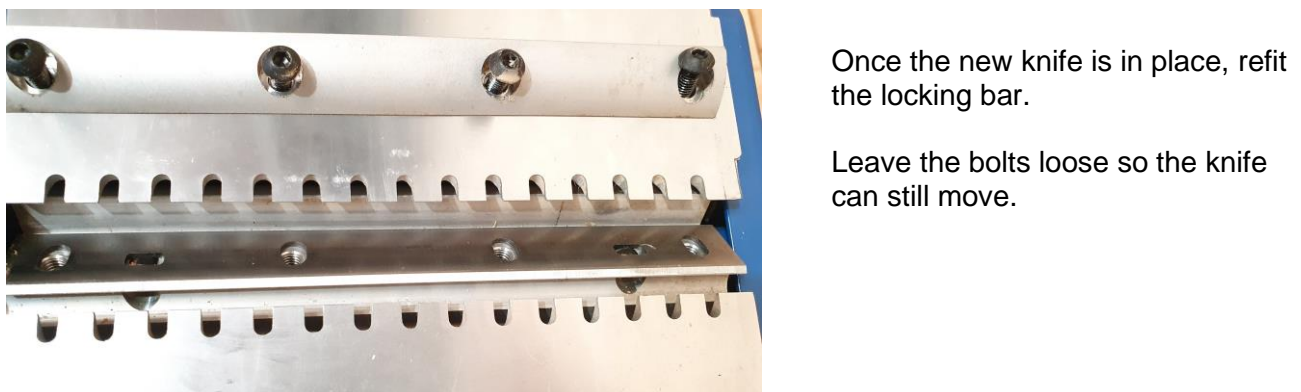
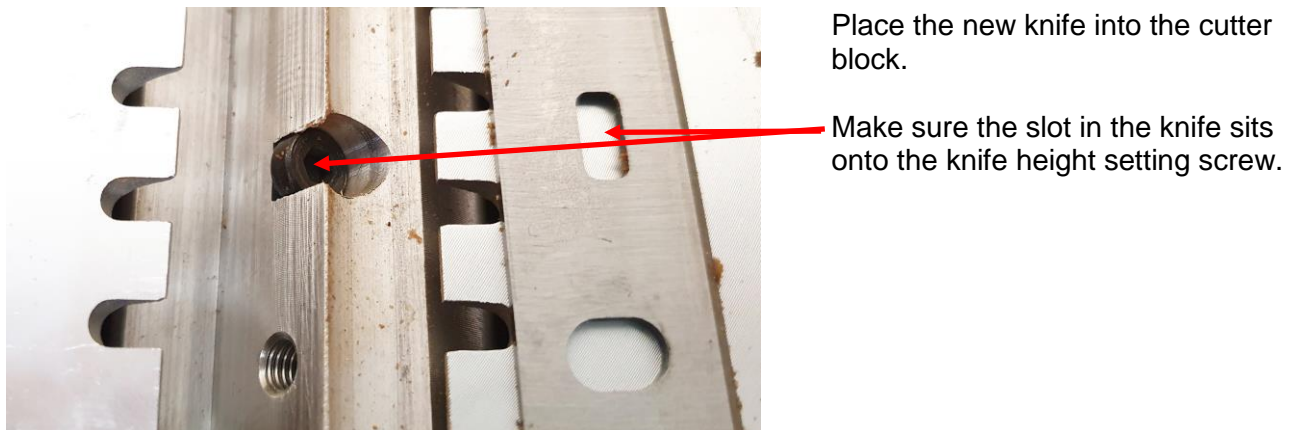
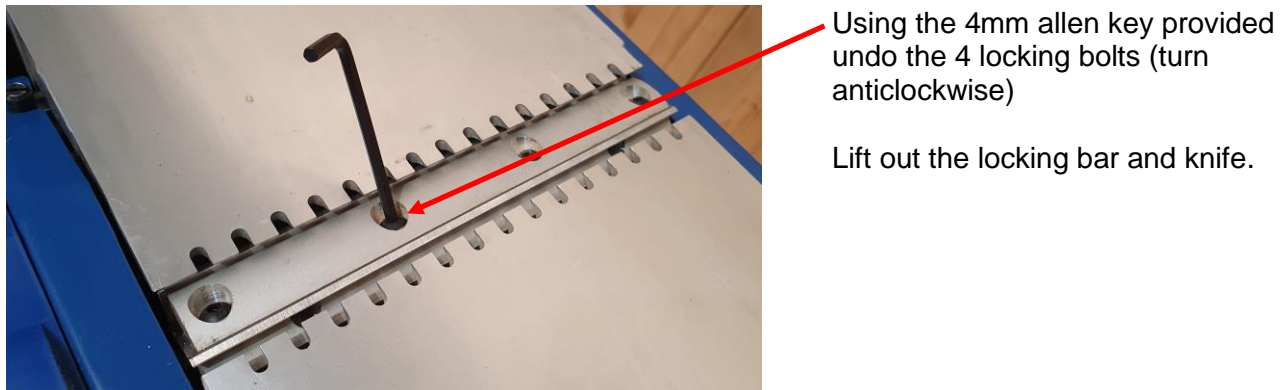
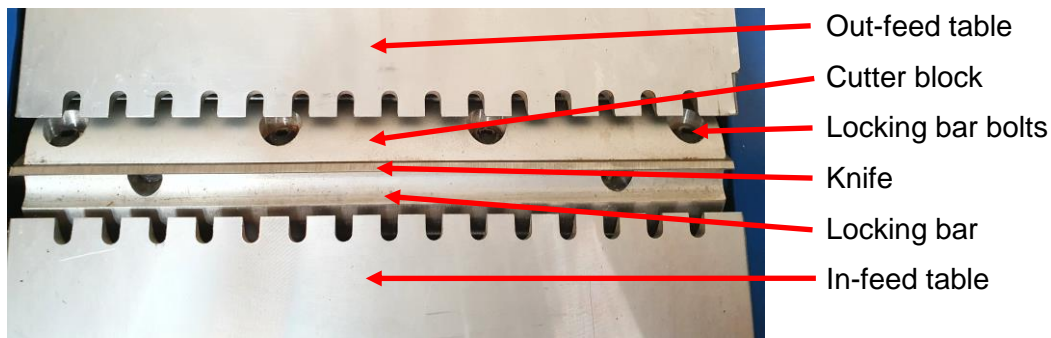

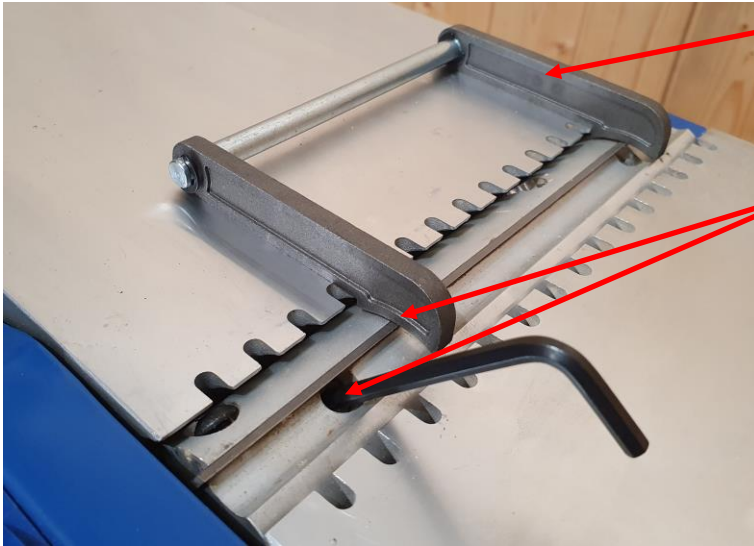

Place the knife height setting jig on the out-feed table with the curved section sitting over the knife and cutter block.

Using the Hex key, Adjust the blades if needed so that they just touch the curved section of the setting jig.

Tighten the 4 locking bar bolts and ensure it is firmly locked in place.

Repeat these steps for the second knife. Check that the blades do not contact the edge of the table.

Troubleshooting

Problem	Cause	Remedy
Machine does not start	Blown Fuse	Replace Fuse
	Loose switch terminal	Inspect back of switch
	Faulty switch	Replace switch
	Guard not fitted	Re-fit the plastic guard ensuring it connects with the interlock switch
Only starts when Green button is held down	Faulty switch	Replace switch
Machine runs intermittently	Worn carbon brushes in motor	Replace carbon brushes
Motor running but cutter block is not rotating	Broken or stretched drive belt	Replace drive belt
Motor slows down during the cut	Depth of cut is too great	Take a smaller cut
	Dust & Chip collector hood is blocked	Clear the blockage and ensure the extractor is functioning correctly
	Planing knives are blunt	Replace knives
Excess Vibration	Planing knives out of balance	Reset the height of the knives

Declaration of Conformity

Charnwood Declare that Woodworking Planer & Thicknesser, Model PT200

Conforms with the following EU Directives: Machinery Directive 2006/42/EC
EMC Directive 2014/30/EU

Conforms with the following UK Regulations: Supply of Machinery (Safety) Regulations 2008
Electromagnetic Compatibility Regulations 2016

And further conforms to the machinery example for which the EC type examination Certificate No. MDC2045 & SHEM171100805401TLC have been issued by SGS United Kingdom, Unit 12, Bowburn South Ind Est, Bowburn, Durham, DH6 5AD.

I hereby declare that equipment named above has been tested and found to comply with the relevant sections of the above referenced specifications. The machinery complies with all essential requirements of the directives & regulations.

Signed: 

Dated: 16/06/2021

Location: Leicestershire

Richard Cook, Director



Please dispose of packaging for the product in a responsible manner. It is suitable for recycling. Help to protect the environment, take the packaging to the local amenity tip and place into the appropriate recycling bin.



Only for EU countries

Do not dispose of electric tools together with household waste material!

In observance of European Directive 2002/96/EC on waste electrical and electronic equipment (EEE) and its implementation in accordance with national law, electric tools that have reached the end of their life must be collected separately and returned to an environmentally compatible recycling facility. Your local refuse amenity will have a separate collection area for EEE goods



Charnwood PT200 Parts Diagram

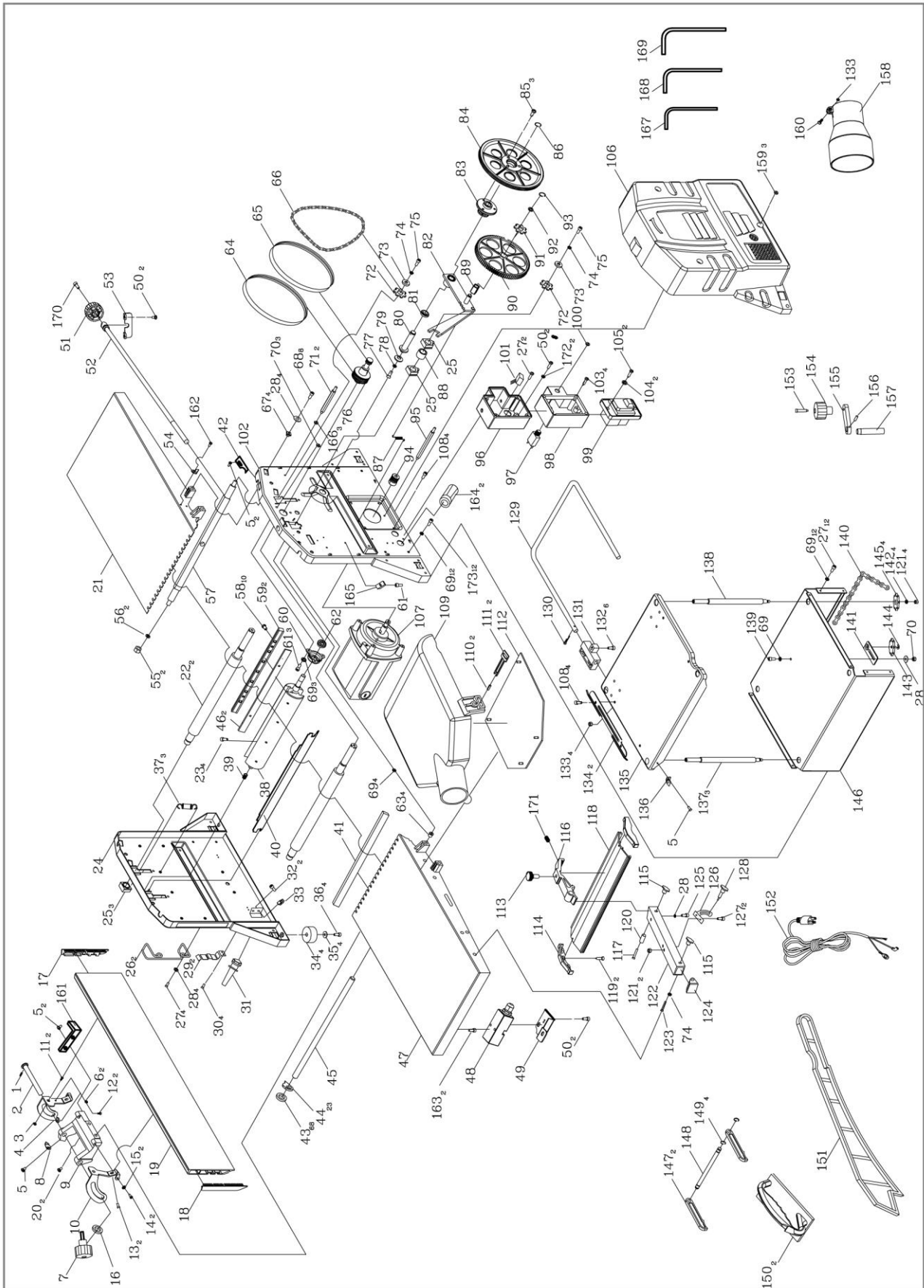

Charnwood PT200 Parts List

Part No	Description	Part No	Description
PT200#001	Pin 3x10	PT200#046	Blade
PT200#002	Fence Pivot Shaft	PT200#047	Outfeed Planin Table
PT200#003	Hex Nut M6	PT200#048	Safety Switch
PT200#004	Right Hand Fence Tilt Bracket	PT200#049	Safety Switch Bracket
PT200#005	Screw M4 X 8	PT200#050	Screw M5 x 10
PT200#006	Hex Nut m4	PT200#051	Planing Depth Knob
PT200#007	Locking Knob	PT200#052	Planing Depth Adjustment Bar
PT200#008	Pointer	PT200#053	Bracket
PT200#009	Fence Casting	PT200#054	Pointer
PT200#010	Left Hand Fence Tilt Bracket	PT200#055	Nyloc Nut M8
PT200#011	Hex Screw M6 x 12	PT200#056	Spring Washer M8
PT200#012	Hex Screw M4 x 20	PT200#057	Depth Adjustment Bar
PT200#013	Screw M4 x 10	PT200#058	Bolt M6 x 12
PT200#014	Hex Cap Screw M4 x 10	PT200#059	Blade Locking Bar
PT200#015	Washer 4mm	PT200#060	Bracket
PT200#016	Washer 6mm	PT200#061	Bearing K10x13x13
PT200#017	Fence Right Hand End Cap	PT200#062	Bearing 6000Z
PT200#018	Fence Left Hand End Cap	PT200#063	Spacer
PT200#019	Fence Extrusion	PT200#064	Feed Roller Belt - 3PJ610
PT200#020	Bolt M6 x 20	PT200#065	Drice Belt - 5PJ610
PT200#021	Infeed Planing Table	PT200#066	Chain 081 x 36 x 12.7
PT200#022	Feed Roller	PT200#067	Spacer
PT200#023	Blade Height Adjustment Screw	PT200#068	Bolt M5 x 30
PT200#024	Rear Panel	PT200#069	Washer
PT200#025	Block	PT200#070	Nut M5
PT200#026	Cable Tidy Bracket	PT200#071	Spacer Bar
PT200#027	Screw M5 x 10	PT200#072	Upper Sprocket
PT200#028	Washer Assembly M5 x 10	PT200#073	Washer 6mm
PT200#029	Push Stick Bracket	PT200#074	Locking Washer
PT200#030	Screw M3 x 6	PT200#075	Screw M6 x 16
PT200#031	Cable Gromet	PT200#076	Top Drive Belt Pulley
PT200#032	Screw M4 x 16	PT200#077	Bolt M8 x 16
PT200#033	Strain Relieif Plate	PT200#078	Locking Washer 8mm
PT200#034	Rubber Foot	PT200#079	Washer 8mm
PT200#035	Washer 8mm	PT200#080	Shaft
PT200#036	Bolt M8 x 20	PT200#081	Spacer
PT200#037	Spring	PT200#082	Connection Plate
PT200#038	Cutter Block	PT200#083	Small Feed Roller Gear
PT200#039	Retainer Support M4 x12	PT200#084	Large Feed Roller Belt Wheel
PT200#040	Safety Bar	PT200#085	Screw M5 x 15
PT200#041	Sponge Strip	PT200#086	Washer
PT200#042	Positioning Plate	PT200#087	Spring
PT200#043	Spacer	PT200#088	Spacer
PT200#044	Anti Kick Back Tooth	PT200#089	Spigot
PT200#045	Anti Kick Back Bar	PT200#090	Large Feed Roller Gear

Part No	Description	Part No	Description
PT200#091	Lower Sprocket	PT200#136	Pointer
PT200#092	Washer 10mm	PT200#137	Rise and fall lead screw
PT200#093	Split Washer 8mm	PT200#138	Rise and fall lead screw
PT200#094	Lower Drive Belt Pulley	PT200#139	Bolt M5 x 12
PT200#095	Spacer Bar	PT200#140	Chain 05B x 136 x 8
PT200#096	Switch Box	PT200#141	Tension Plate
PT200#097	Reset Button	PT200#142	Washer 5mm
PT200#098	Switch Box Cover	PT200#143	Cog
PT200#099	Switch	PT200#144	Split Washer 5mm
PT200#100	Nut	PT200#145	Cog
PT200#101	Capacitor 0.33mf	PT200#146	Base Plate
PT200#102	Front Panel	PT200#147	Blade Setting Jig Arm
PT200#103	Self Tapping Screw 9 x 10	PT200#148	Blade Setting Jig Joining Bar
PT200#104	Washer 3mm	PT200#149	Washer 6mm
PT200#105	Self Tapping Screw 9 x 16	PT200#150	Push Pad
PT200#106	Plastic Side Cover	PT200#151	Push Stick
PT200#107	Motor	PT200#152	Power Cable
PT200#108	Screw M5 x 12	PT200#153	Screw M6 x 33
PT200#109	Dust Guard	PT200#154	Crank Handle Knob
PT200#110	Split Pin 3 x 14	PT200#155	Crank Handle
PT200#111	Dust Guard Lock Key	PT200#156	Pin 3 x 20
PT200#112	Dust Guard Base Plate	PT200#157	Crank Handle Shaft
PT200#113	Bridge Guard Knob	PT200#158	100mm Dust Adaptor
PT200#114	Bridge Guard End cap	PT200#159	Dome Nut M5
PT200#115	Plastic Knob	PT200#160	Screw M5 x 16
PT200#116	Brdige Guard Bracket	PT200#161	Safety Bracket
PT200#117	Coach Bolt M6 x 30	PT200#162	Screw M4 x 8
PT200#118	Bridge Guard	PT200#163	Screw M4 x 25
PT200#119	Self Tapping Screw 2 x 8	PT200#164	Gromet
PT200#120	Spacer	PT200#165	Cable Clamp
PT200#121	Lock Nut M5	PT200#166	Nut M5
PT200#122	Bridge Guard Arm	PT200#167	4mm Allen Key
PT200#123	Hex Screw M6 x 35	PT200#168	5mm Allen Key
PT200#124	Screw M5 x 25	PT200#169	6mm Allen Key
PT200#125	Bolt M5 x 16#	PT200#170	Screw M5 x 12
PT200#126	Bridge Guard Height Bracket	PT200#171	Nylon Grub Screw M6 x 8
PT200#127	Bolt M5 x 35	PT200#172	Washer 5mm
PT200#128	Bridge Guard Height Knob	PT200#173	Screw M5 x 8
PT200#129	Extension Table	PT200#174	Lead Screw Sheath
PT200#130	Cotter Pin 2.5 x 25		
PT200#131	Extension Table Bracket		
PT200#132	Bolt M5 x 18		
PT200#133	Nut M5		
PT200#134	Thickness Table Side Guide		
PT200#135	Thickness Table		

Updated June 2021



Woodworking machinery at its best!

Charnwood, Cedar Court, Walker Road, Hilltop Industrial Estate, Bardon,
Leicestershire, LE67 1TU

Tel. 01530 516 926 Fax. 01530 516 929

email: sales@charnwood.net website: www.charnwood.net