

USER'S MANUAL

Swing Set TY589394

THIS INSTRUCTION BOOKLET CONTAINS **IMPORTANT** SAFETY INFORMATION. PLEASE READ AND KEEP FOR FUTURE REFERENCE.

Please give us a chance to make it right and do better!

Contact our friendly customer service department for help first.

Replacements for missing or damaged parts will be shipped ASAP!

Follow Costway



Contact Us!

Do NOT return this item.

Contact our friendly customer service department for help first.



Before You Start

Please read all instructions carefully and keep it for future reference.

Warnings:

Attention: For home use only.

Attention: The Product is not suitable for the children under 3 years

Danger: Keep all small parts and packaging materials for this product away from babies and children, otherwise they may pose a choking hazard.

Danger: Lack of attachment may cause a risk of tipping or fall hazards.

General Warnings:

- △ The product must be installed and used under the supervision of an adult.
- △ Read through each step carefully and follow the proper order.
- △ Remove all packaging, separate and count all parts and hardware.
- △ Please ensure that all parts are correctly installed, incorrect installation can lead to a danger.
- △ We recommend that, where possible, all items are assembled near to the area in which they will be placed in use, to avoid moving the product unnecessarily once assembled.
- △ Ensure a secure surface during construction, and place the product always on a flat, steady and stable surface.
- △ Please check and maintain regularly, the most important parts for suspension, fixing, anchoring to the ground.

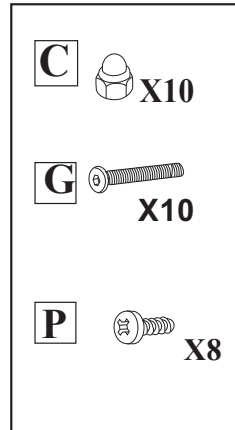
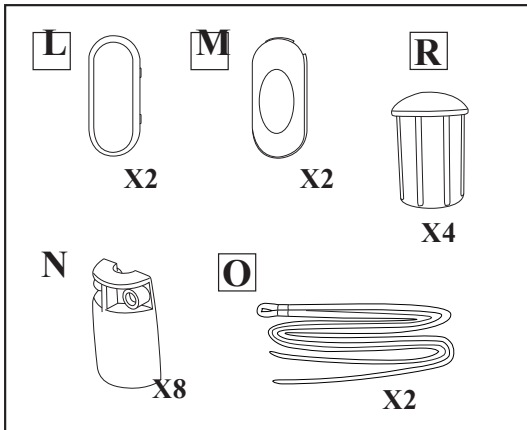
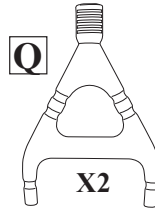
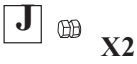
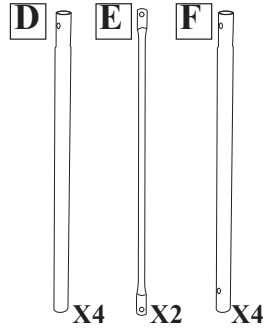
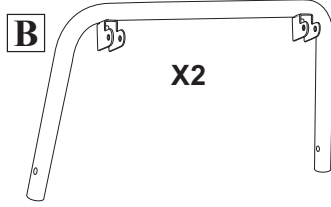
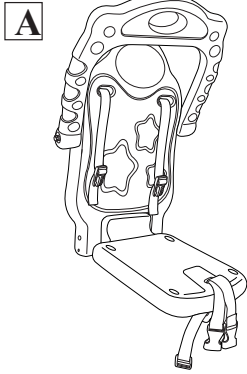

1

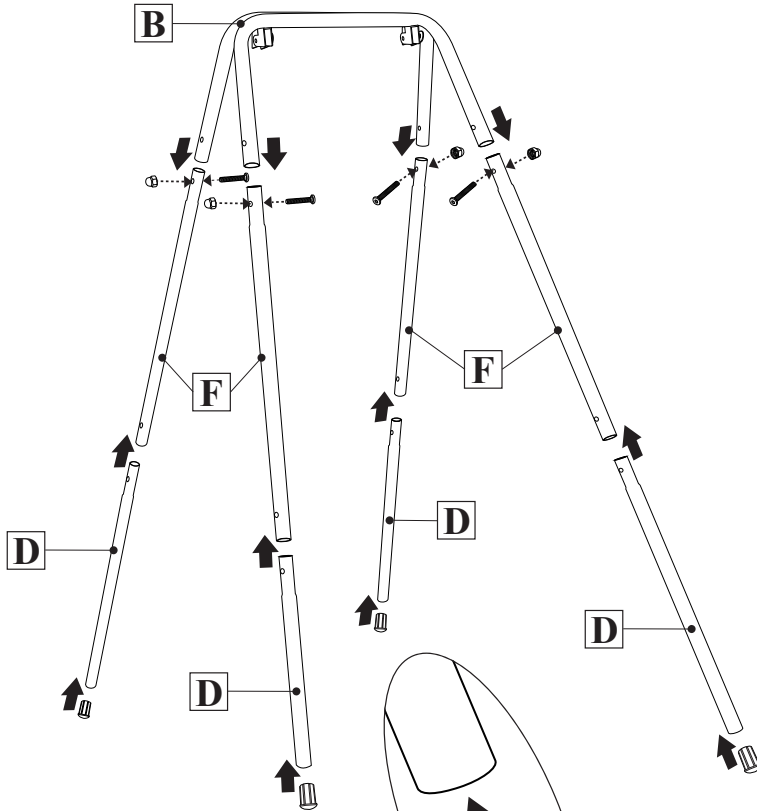

Step 1. Lock the C G screws on the B D F iron pipes as shown in the figure, and install the R fittings to the four legs of the iron frame.

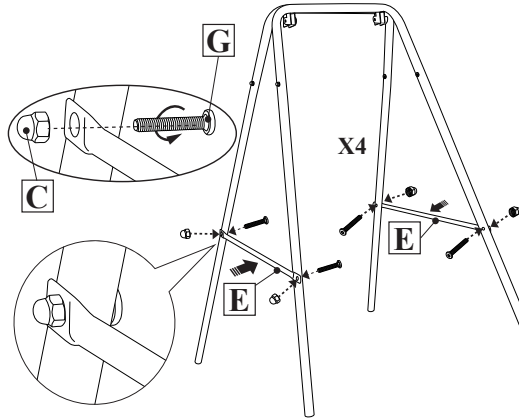
2

Step 2. Lock the C G screws on the E iron pipe as shown in the figure. The iron frame installation is completed.

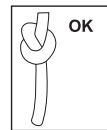
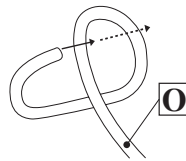
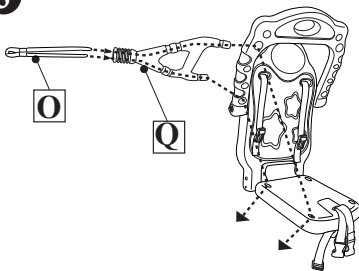
3

Step 3. Thread the rope on the armrest according to the dotted line, and tie a knot under the seat. The operation method is the same on the other side.

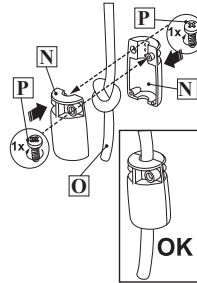
4

Step 4. At the knot under the seat base, close the N plastic parts and lock the P screws to fix it.

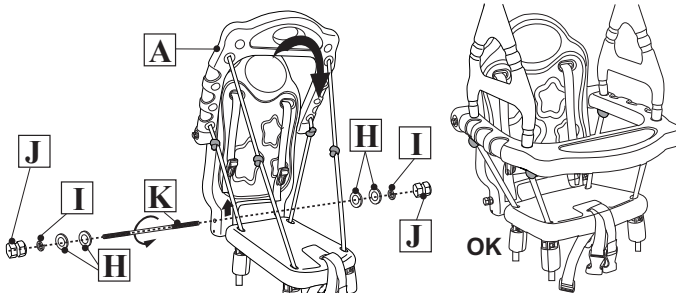
5

Step 5. Put on the iron shaft at the connection of the seat base and fix it with screws. The seat installation is completed.

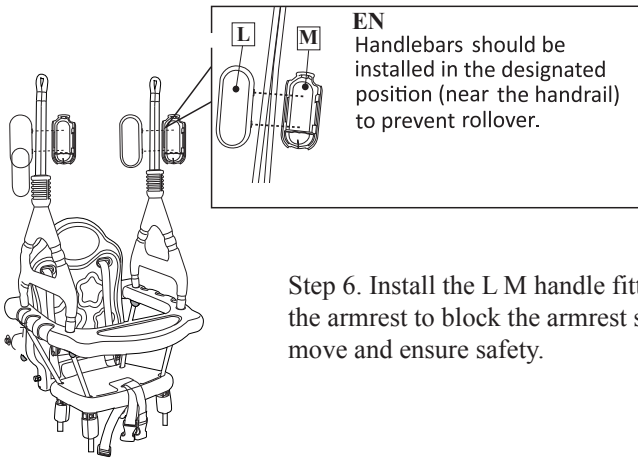
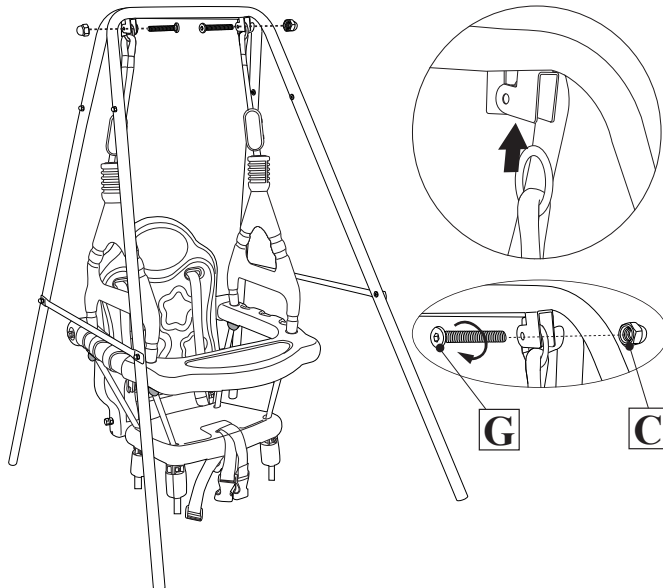
6**7**

Step 7. Fix the seat with the rope on the iron frame with C G screws. The entire installation is completed.